



ARISTARCHOS

131' 3" (40m) | Nautor's Swan | 2006

ARISTARCHOS

BASIC SPECIFICATIONS

BUILDER

Nautor's Swan

BEAM (ft/m)

28' (8.53m)

CRUISING/MAX SPEED

14 / 14.5 Knots

CREW

6

RANGE

2000 nm

LENGTH (ft/m)

131' 3" (40m)

DRAFT (ft/m)

16' 1" (4.88m)

FUEL CONSUMPTION

150 Litres/Hr

ACCOMMODATION

12 guests in 3 cabins

INTERIOR DESIGNER

Nautors - Dick Young

BUILT/REFIT

2006 / 2020

GROSS TONNAGE

185 GT

ENGINES

2 x Caterpillar 480 hp

ARRANGEMENTS

2 Double, 1 Twin

ARISTARCHOS

KEY FEATURES

- › THE ONLY 30M+ SWAN IN THE GREEK WATERS
- › LUXURY AND ELEGANT INTERIOR
- › TRUE SAILING YACHT

ARISTARCHOS

WATER TOYS

- › 1 X JET CASTOLDI 5.50M WITH 125 HP YANMAR
- › 1 X ZODIAC 3.80M
- › 1 X SET WATER SKIS (ADULTS)
- › 1 X MONO SKI
- › 1 X WAKE BOARD
- › 4 X SUP
- › 1 X SEABOB
- › TUBES
- › SNORKELING GEAR
- › FISHING GEAR

ARISTARCHOS

WATER TOYS

ARISTARCHOS



ARISTARCHOS



ARISTARCHOS



ARISTARCHOS



ARISTARCHOS



















ARISTARCHOS



ARISTARCHOS



ARISTARCHOS

ARISTARCHOS
PIRAEUS



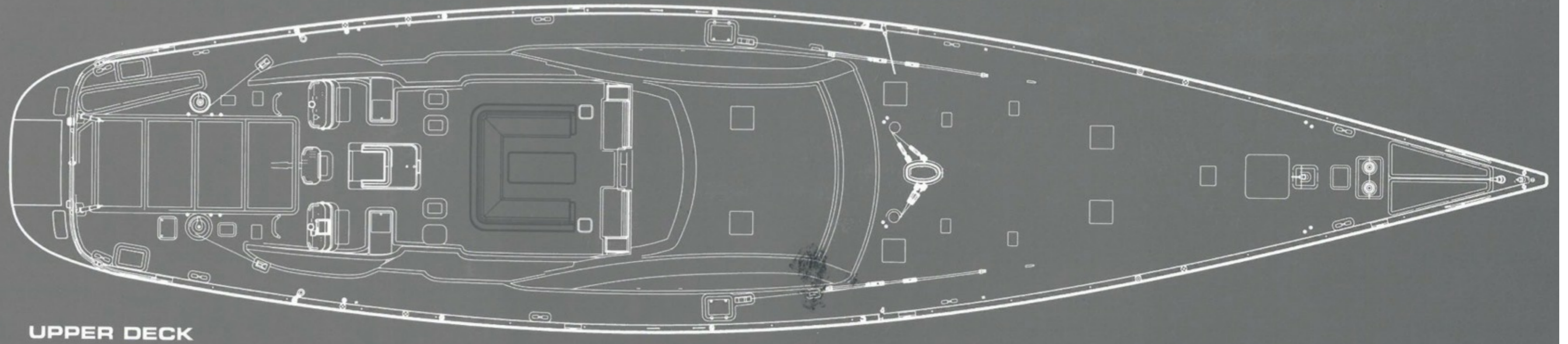

UPPER DECK

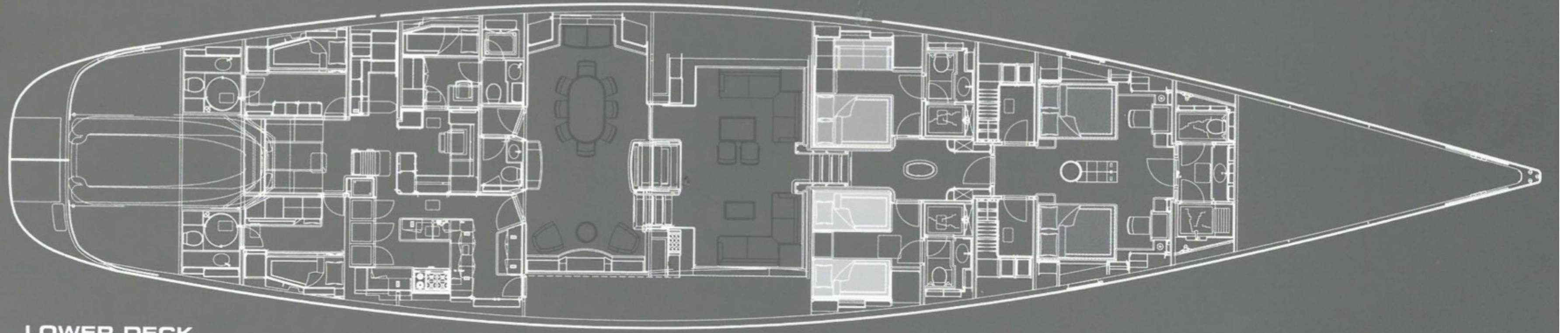

LOWER DECK

MASTER CABIN

DOUBLE CABIN

TWIN CABIN