

C L O U D B R E A K

1



CLOUDBREAK

F O R C H A R T E R



CLOUDBREAK

75.28 | ABEKING & RASMUSSEN | 2016

 LENGTH 75.28m

 BEAM 12.4m

 NO. OF GUESTS 12

 MAX SPEED 15kts

 GUEST CABINS 6

 RANGE 8500

CLOUDBREAK

There's so much more to enjoy on CLOUDBREAK – like the large pool on the sundeck, or ample space for sunbathing and alfresco dining opportunities. If you want to head indoors, you can watch a screening of your GoPro footage in CLOUDBREAK's state-of-the-art cinema room, enjoy drinks in the chalet-inspired saloon, or watch the night sky from her winter garden.

KEY FEATURES

- Master cabin has two balconies: one enclosed & one completely open
- Huge wellness centre and gym with a large open balcony
- Extensive selection of water toys
- Eagle nest - observation tower
- Winter garden on the bridge deck





A D V E N T U R E

- Charter this exceptional explorer yacht in some of the most exotic and exciting destinations in the world!
- Designed by Espen Oeino with a Christian Liaigre interior and built with exceptional northern European quality at Abeking and Rasmussen, the yacht is loaded with every imaginable tender and toy to ensure you and your guests experience these exotic locations to the fullest.
- CLOUDBREAK is undoubtedly the best equipped and most luxurious expedition yacht ever launched.

V I D E O

E X P L O R E

On her round-the-world voyage you can charter her in one of the many thrilling and exotic locations that she will visit. Surf undiscovered breaks, dive some of the world's best dive locations or simply relax and let the professional, multi-skilled crew take care of you in absolute luxury in any of these remote, exotic locations.





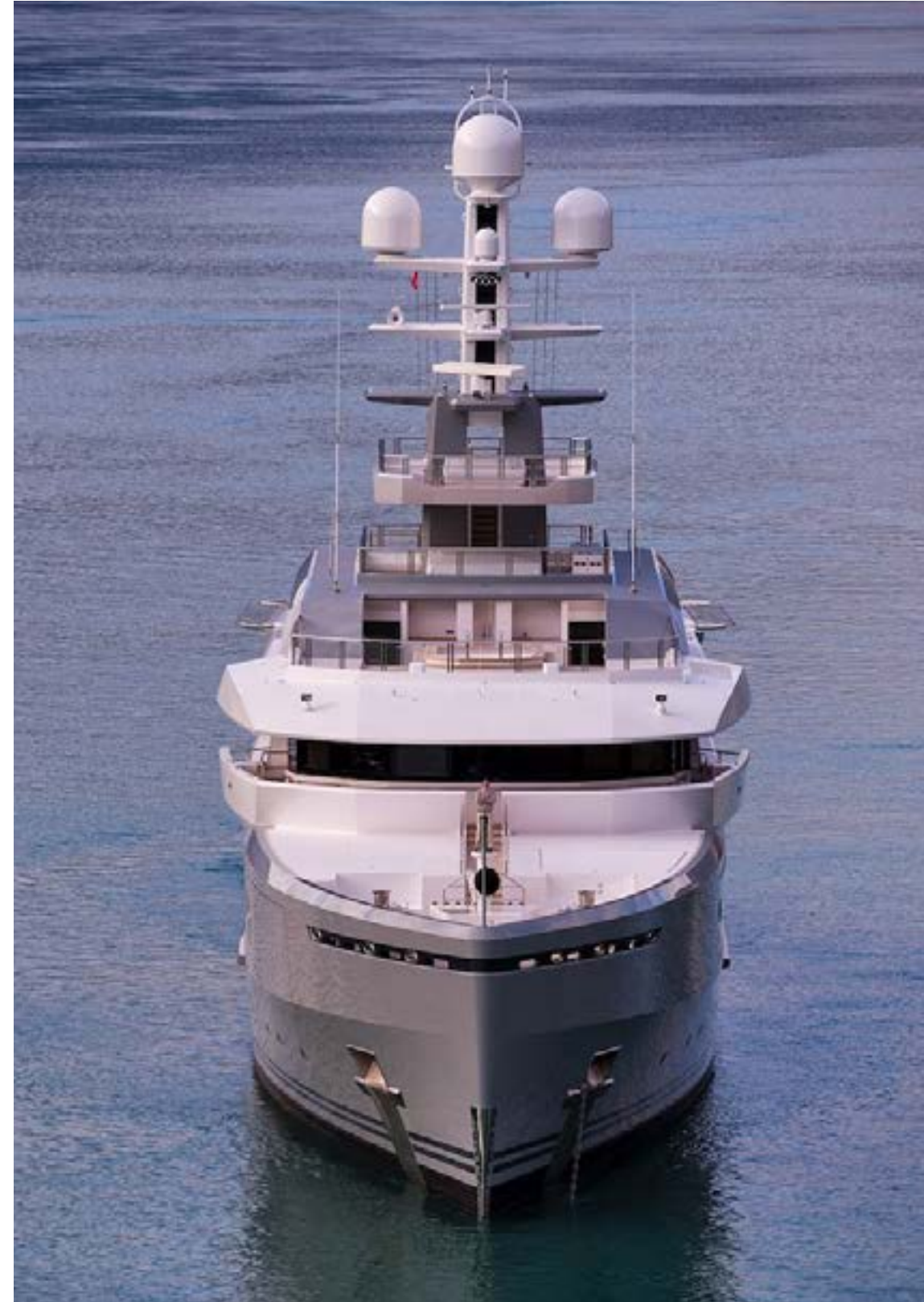























LOWER DECK GUEST BATHROOM 1



















MAIN DECK FIREPLACE LOUNGE





MAIN DECK SALON





MAIN DECK ELEVATOR



MAIN DECK OWNER'S NOOK







MAIN DECK OWNERS BALCONY





M A I N D E C K O W N E R ' S B A T H R O O M



































SUNDECK POOL AREA













OBSERVATION DECK



T E N D E R S

FOUR TENDERS

- 12m Custom Cockwells Tender (2022)
- 10m X Tender Carbon Fiber Custom Beach Lander (2017)
- 6m Highfield Aluminium Custom Patrol 600 (2021)
- 4.5m Survitec Ribo (2020)





T O Y S

TOYS, EQUIPMENT & ACCESSORIES

- 2x Jetskis - Yamaha Waverunner FX Cruiser HO (2020 Models)
- 4x Seabobs - F5 S
- 2x Yamaha Sea Scooter (Kids Seabob)
- 2x Lift Foil Electric Foil boards – Lift e2
- 2x Awake Ravik S Electric Surfboards
- Wakeboards & Skis. Ronix, Slingshot, Hyperlite, Jobe, O'brien and Connelly
- 16x S.U.Ps – 2x Aztron 10ft8, 4x Starboard 11ft-12ft, 2x Sic Maui Custom 14ft, 1x Cohete 11ft6, 2x JP 9ft, 2x Custom ZEAL 12ft, 1x Fanatic 11ft, 2x Sunova 9ft
- 21x Surfboards - Various Brands and Styles (including a Burton 7.2 and a 6.8 Fat Bullet (Multi-fin, Round Tail), SOS 8 Minimal Thruster, Absolute 8.2 Mal, Absolute 5.8 Fish Tail and Rusty 6 Swallow Tail)
- Kitesurfing Gear – 2x 2016 Cabrinha twin-tip's boards, 1x 2016 Cabrinha directional board and 5x Cabrinha kites (6m, 8m, 10m, 12m, 15m) Contra and Drifter Models. 3x Dakine Harnesses
- Windsurfing Gear – 12x 2016 Neil Pryde and Goya Sails & 4x 2016 Goya Boards & 4x 2016 Masts with 4x 2016 Booms and 3x 2016 Dakine harnesses
- Wing Foil Gear – 2x Duotone Slick Wings 4m & 6m and 2x Cabrinha Crosswing X3 5m and 7m and 1x Cabrinha Slingwing V2 4m
- Foil Boards & Foils – 2x 2022 Fanatic Sky Wing Boards 5'4" and 5'8", Fanatic Foils Aero High Aspect Range AL 3.0, Mast fuselage 750/780, Foil Wing 1750/300 & 1500/250) 1x 2021 F-One Rocket Air 7ft (inflatable Foil board)
- Mountain Bikes – 8x BMC Four strokes

T O Y S

TOYS, EQUIPMENT & ACCESSORIES (CONTINUED)

- Towable & Inflatables – 1x Jobe Scout 3 Person, 1x Jobe Sonar 4 person, 1x Jobe Storm 2 person
- Adventure Kayaks – 2x Stealth 475 Fisher pro, 2x Venture Islay, 2x Winner Vue 3 Transparent bottom
- 1x Zapata Flyboard
- 1x Hobie Elliptical Board
- 2x RS Aero Sailing boats with 7m and 9m Sail configurations
- 2x Jet Ski Surf Rescue Sleds
- Dive Equipment for 8x Adults and 2x kids
- 17x Various brands of Snow ski's, plus boots, bindings, poles and other accessories
- 7x Burton Snowboards, plus K2 boots and Burton bindings



S P E C I F I C A T I O N S

COMMUNICATIONS EQUIPMENT

- VSAT SeaTel 6012-19 & 6012-33 dual antennas with arbitrator. Currently with 7.6/2.1 CIR 36.1/4.1 MIR Bandwidth.
- 2 x Sailor 500 FleetBroadband
- 4 x Iridium Portable Satellite Phones
- 1 x Pepwave MAX HD4 4G Mobile Router
- 1 x Pepwave MAX HD2 MBX 5G Mobile Router

AUDIO-VISUAL

- Bespoke Video on Demand (VOD) System, PULSE. 3000+ Movies and TV shows. (RUS & ENG)
- Sky UK (via Plexus IPTV)
- Magbox IPTV
- Kartina TV
- PlayStation 4
- Karaoke server.
- KNX lighting, blinds and climate control.
- All areas controlled with Crestron Via 55x Apple iPad Minis in each room.
- Apple TVs' for all rooms

AUDIO-VISUAL (CONTINUED)

- AM/FM radio tuner
- RadioPark internet Radio
- Mirage Music server and Library
- Pinoneer CDJ system
- Full Party Lighting helideck setup Via GrandMA
- News & Magazines via PressReader delivered to guests on Large iPad Pro's
- Spotify Music Streaming throughout vessel
- Oculus YachtEye Infotainment
- California Audio Technology Speakers & Amplifiers
- DANTE Audio control
- Pharos Lighting Control

PHOTO AND VIDEOGRAPHY

- Apple & Adobe Premier Video Editing suite for onboard videos
- DJI Drones & film equipment
- Inspire 2
- 2x Mavic Pro
- Ronin S
- Phantom Pro
- Canon professional Photography Equipment

IT

- Cisco Catalyst enterprise switches
- Cisco Call Management and phones
- Cisco Wireless LAN controller and Access points
- Remote stewardess call with Crestron and Cisco via AskRoger!
- VMware Virtual management & environments
- IDEA planned maintenance and yacht Management software

OBSERVATION DECK

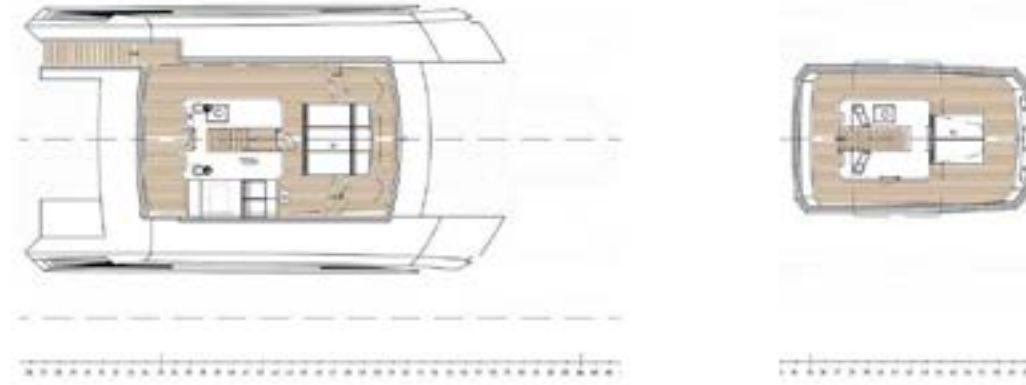

SUN DECK



UPPER DECK

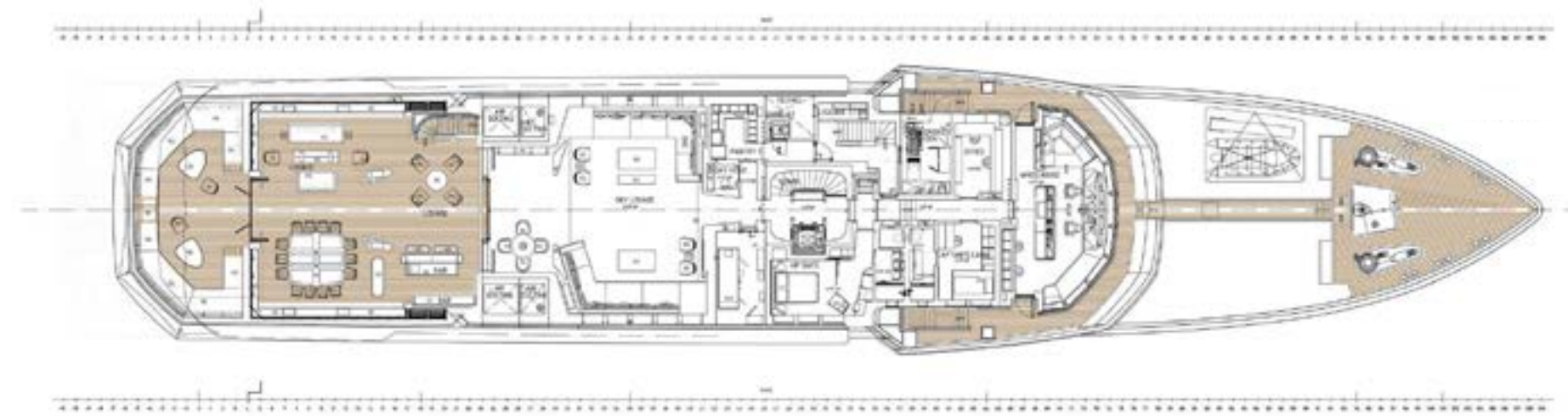

MAIN DECK



LOWER DECK



TANK DECK



- Guest Cabins
- Owners Cabin

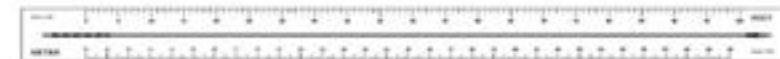

LIAIGRE
MAIN DIMENSIONS

LENGTH OVER ALL	72,25 m / 237,0 ft
LWL	71,38 m / 234,0 ft
BEAM	12,48 m / 40,9 ft
DRAUGHT	3,45 m / 11,3 ft

ARNESEN & RASMUSSEN	
6499	
72 m Motoryacht	
General Arrangement	
GENERAL ARRANGEMENT	
6499/0716-01-11	

DISCLAIMER

While every effort has been made to ensure that the information contained within this presentation is as up-to-date and accurate as possible at the time of going to press, this cannot be guaranteed. All rights reserved. No part of this publication may be reproduced or used in any form.

