

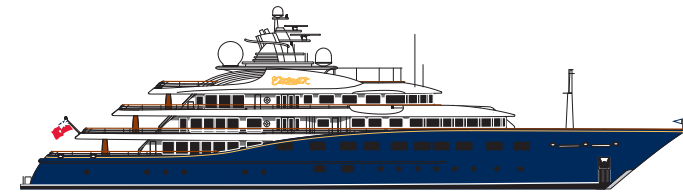

CAKEWALK



AN AMERICAN MASTERPIECE

She is a triumph of engineering, of design, of vision and collaboration. Most of all, Cakewalk is an extraordinary feat of American craftsmanship. Welcome to the largest personal yacht built in America in nearly a century, and the largest yacht by volume ever built in the U.S. From the classic Heywood curves to the exquisite custom joinery and timeless appointments, Cakewalk is a celebration of the hearts and souls of hundreds of skilled hands, coming together to create an American renaissance in quality. Come aboard for your journey of a lifetime.





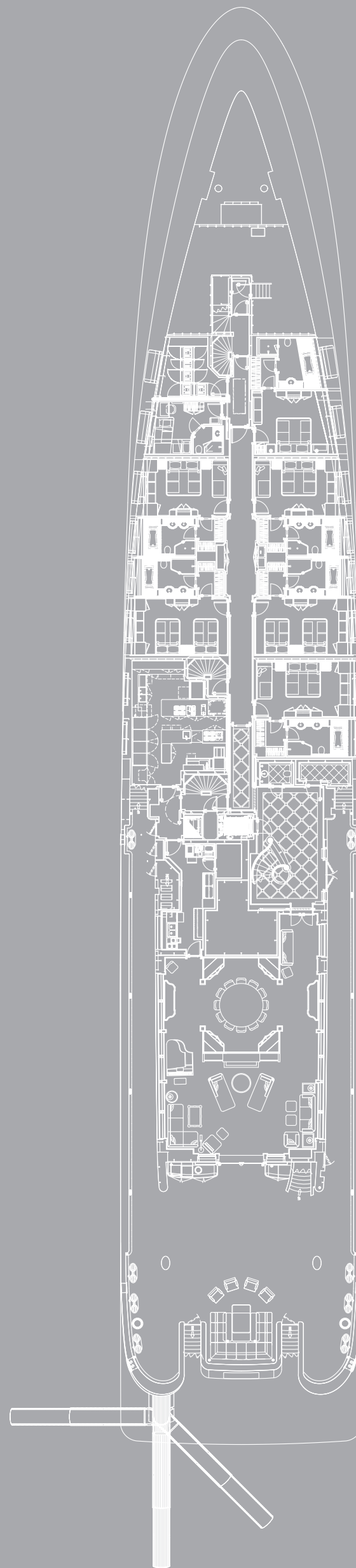

THE MAIN DECK

INTIMACY ON A GRAND SCALE

The elegant swirl of the central staircase, majestically ascending four decks from the main, sets the inviting and expansive tone. Here grandeur is matched equally with graciousness and warmth, from the stunning dining rotunda to the rosewood-paneled library. Cakewalk extends to her guests a peerless level of comfort. All six of the guest cabins enjoy expansive space and views, the result of being here on main deck. And each guest suite is a singular work of art.

GUEST ACCOMMODATION

- 4 Staterooms with King Bed
- 2 Staterooms with Two Double Beds
- 1 Staff / Supernumery Cabin with Two Bunks

Dining Salon

Library with Faux Fireplace

Baby Grand Piano

Aft Deck Lounge Area

Complete Guest Access Level

Elevator

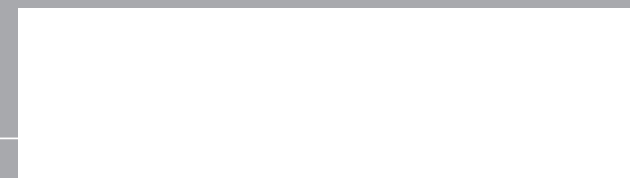













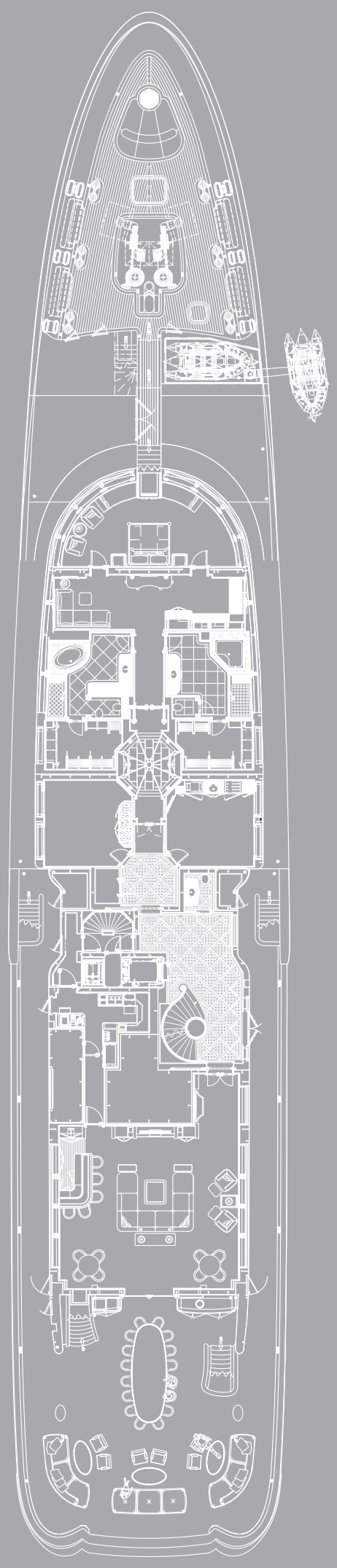

THE OWNER'S DECK

LUXURY DESIGNED TO BE LIVED IN

Among the six cascading decks is the owner's, a seven-room sanctuary whose focal point is the theater room paneled in cerused oak. The tone is one of casual elegance. Here is a place for family gatherings both inside and out, with Cakewalk's premier outdoor dining area at one end of the deck and a spa at the other end. There is no place in the world to call home quite like Cakewalk.

OWNER'S ACCOMMODATION

- Full Beam Accommodation with Panoramic View
- Stateroom with King Bed, A.V. System and Lounge Seating
- Separate Study and Lounge Area
- His & Hers Heads with Jacuzzis
- His & Hers Walk-in Dressing Rooms
- Gym
- Day Spa and Exercise Room
- Theater System
- Bar with Seating for 5
- Card Tables
- Lounge Area
- Powder Room

AFT DECK

- 3 Lounge Areas
- Dining Table that Seats 14









THE OWNER'S DECK FULL BEAM STATEROOM WITH PANORAMIC VIEW, SEPARATE STUDY & LOUNGE AREAS







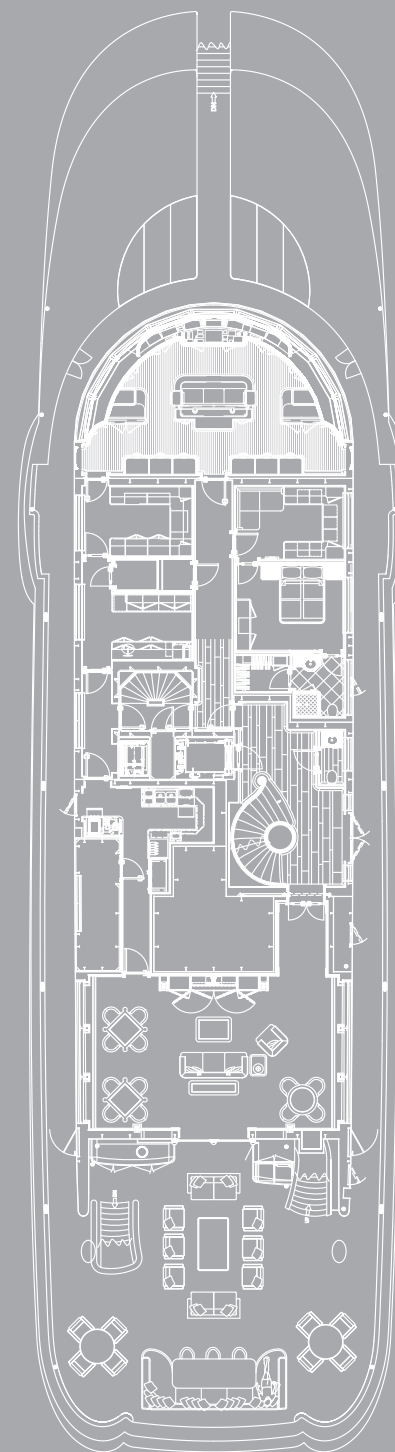

THE BRIDGE

A HEARTBEAT THAT'S STATE OF THE ART
Casual kicks in and kicks back, punctuated by the pecky-cyprus ceilings and rattan furnishings in the card room. It is also here that the heartbeat of this superyacht can be seen in action. On deck are the commanding bridge, captain's office, crew's office and radio room. Aboard Cakewalk, state-of-the-art navigation and security systems are the status quo.

BRIDGE DECK

- Forward Sunbeds
- Wheelhouse
- Ship's Office
- Captain's Cabin
- Captain's Office
- Crew Office
- Powder Room
- Salon
 - Lounge Area
 - A.V. System
 - Card Tables with Seating

AFT DECK

- Lounge Area
- Card Tables with Seating

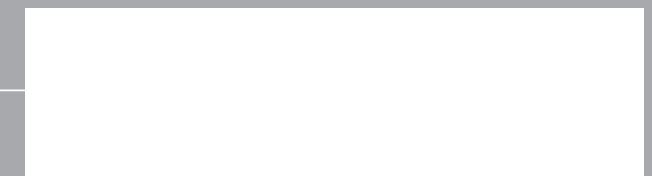









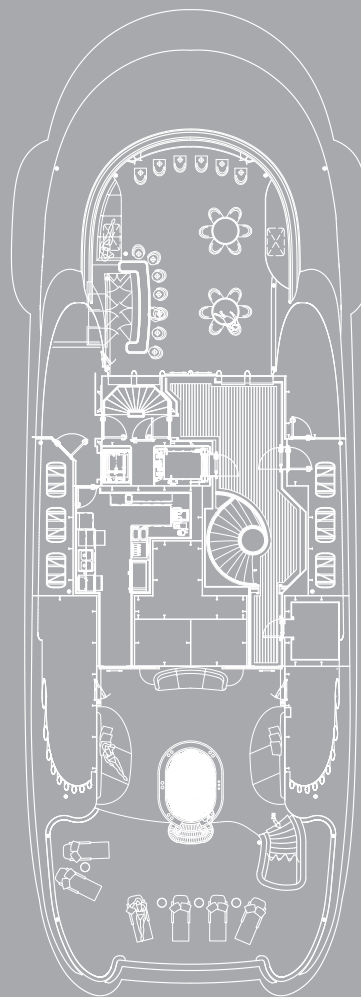

THE SUN DECK

A GRAND PROMENADE BY THE SEA

Cakewalk is legendary for making al fresco fabulous for worshipping the sun and communing with the sea. The sun deck is replete with observation chairs, whirlpool spa and bar. Spacious side decks imbue Cakewalk with the feel of a grand promenade.

FORWARD DECK

- Observation Chairs
- Lounge Areas (Port & Stbd)
- Bar with Seating for 7
- Card Tables with Seating

AFT DECK

- Lounge Area
- Sunbeds
- Whirlpool Spa

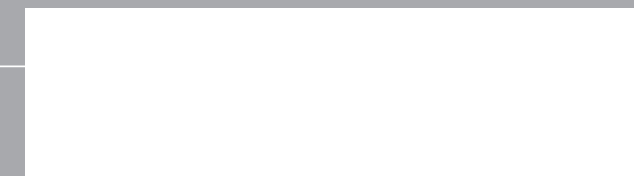

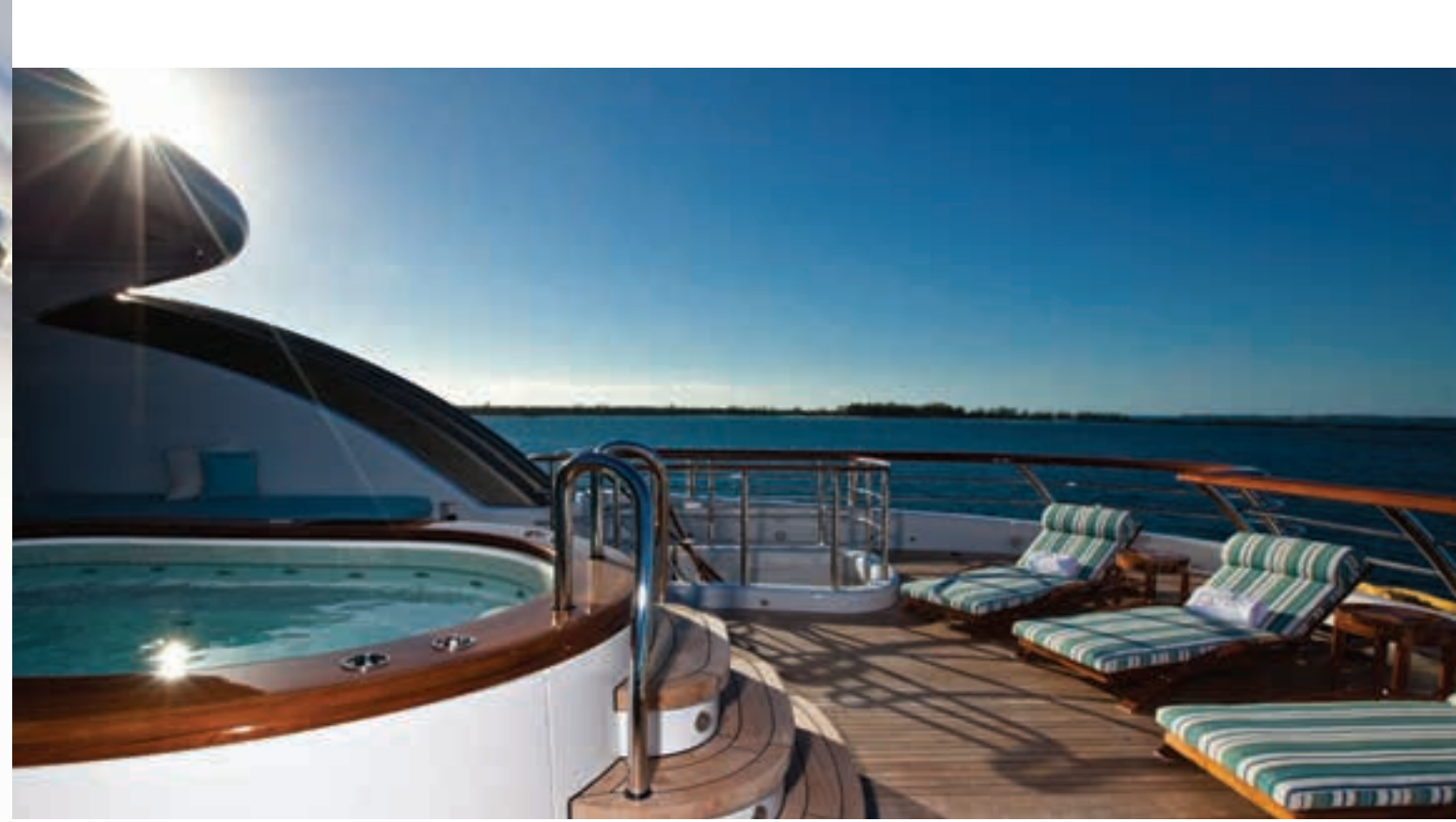

THE SUN DECK AFT LOUNGE AREA & WHIRLPOOL SPA

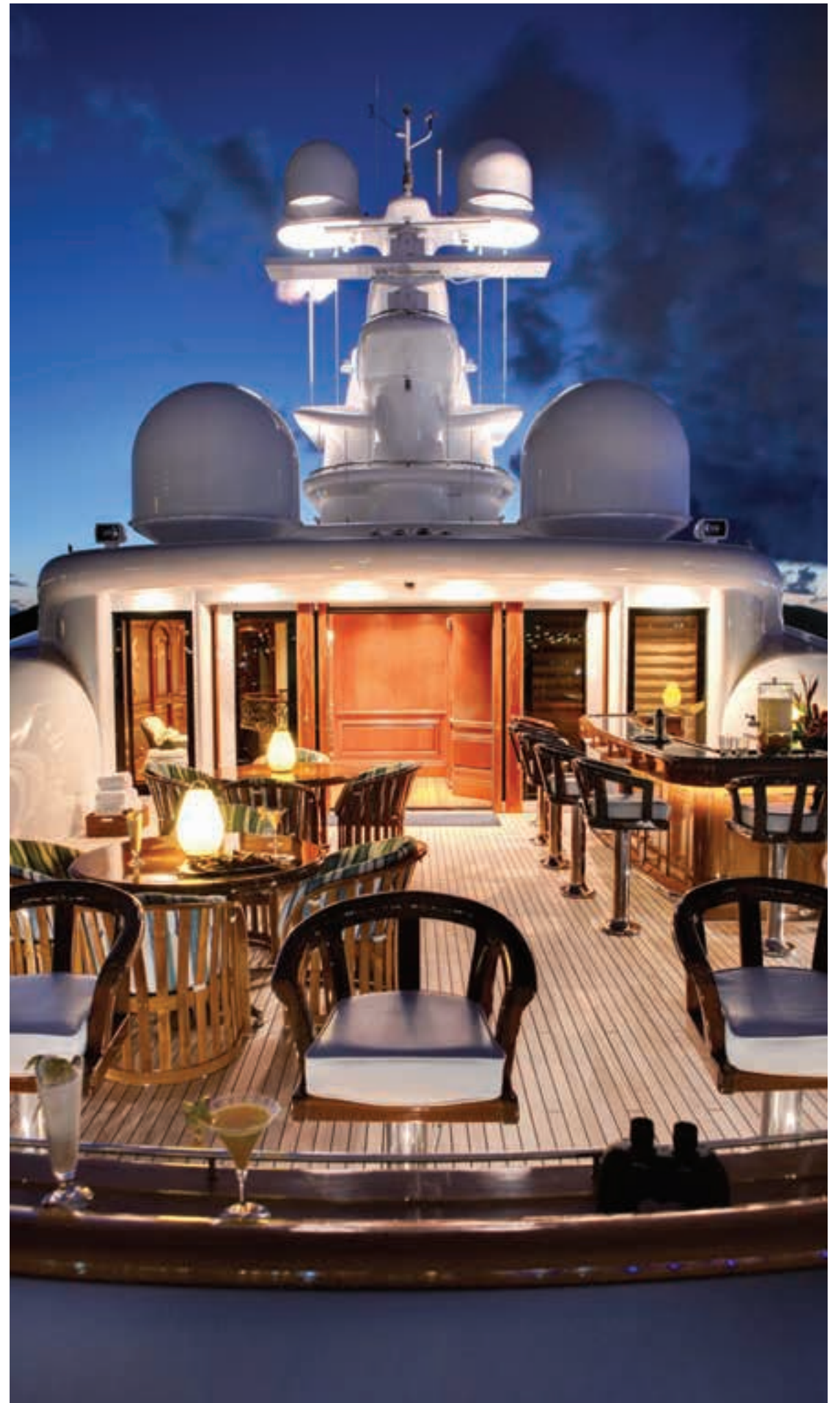

THE SUN DECK FORWARD OBSERVATION CHAIRS & BAR



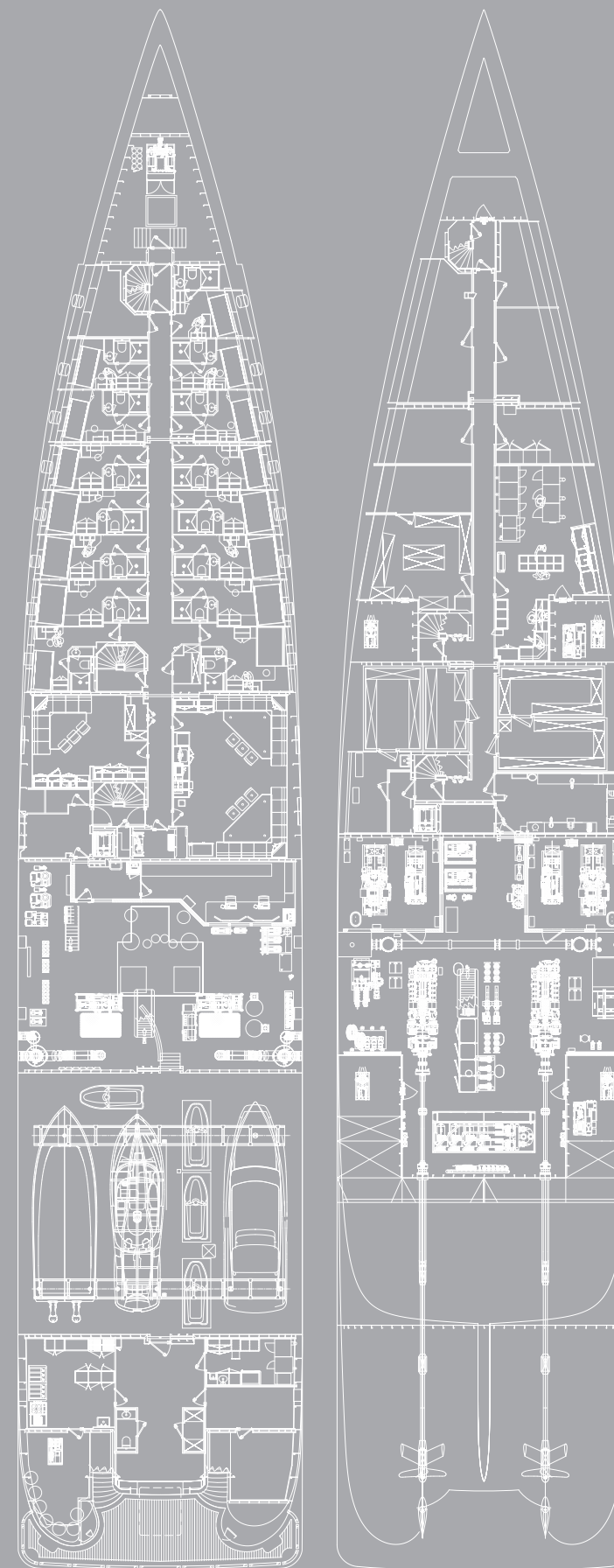

THE LOWER DECK

THE BOTTOM DECK

THE LOWER & BOTTOM DECKS

BELOW DECK, A CUT ABOVE

The 15-cabin crew quarters—the industry's leading crew facilities—are spacious and comfortable, with two mess areas and a gym. In the soundproofed engine room, every pipe and wire is visible for quick maintenance. Welcome to well-engineered engineering!

LOWER DECK

- 15 Crew Cabins
- Officers' Mess
- Crew Mess
- Engine Room
- Inboard Tender & Waverunner Storage
- Lazarette Lounge Area
- Lazarette Dive Room
- Lazarette Powder Room

BOTTOM DECK

- Crew Gym
- Storage
- Laundry
- Engine Room









THE LOWER & BOTTOM DECKS LAZARETTE LOUNGE AREA, INBOARD TENDER AND TOY STORAGE

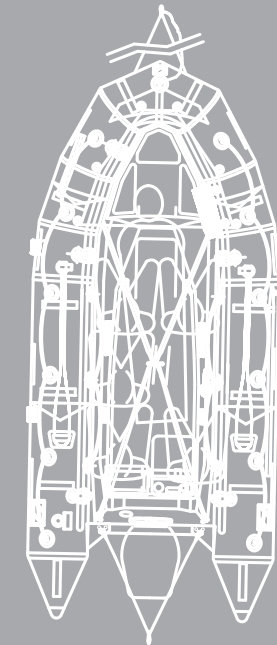
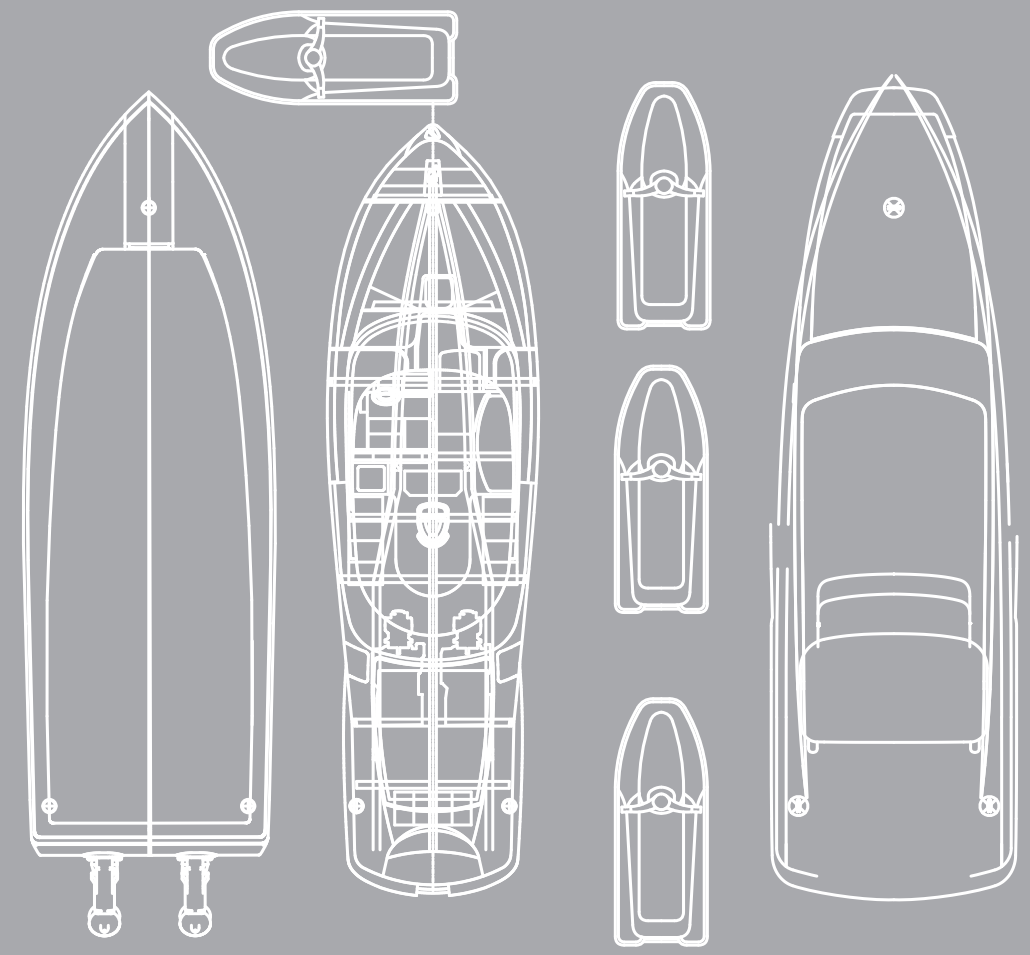

THE TOYS

THE GOLD STANDARD OF THE SEA

A superlative cache of toys brings a special brand of exhilaration to the Cakewalk experience. The tenders tell the tale of Cakewalk's inimitable attention to detail. Housed in a capacious, climate-controlled garage, all three are finished to the same high quality as Cakewalk herself, making it a seamless experience for guests—a magical spell that can't be broken. This is the Cakewalk standard: perfection that goes beyond.

WATERSPORTS & OUTDOOR EQUIPMENT

- 4 Yamaha Waverunners
- 1 custom Nitrox System compressor with cascade dive tank fill system
- Complete SCUBA sets for guests and crew
- Full complement of wetsuits, diving and snorkeling equipment
- 2 Sea Bob water scooters
- Full complement of water skis, kneeboards, wakeboards and inflatable water toys
- Beach party equipment - BBQ, tent, chairs and tables as well as beach equipment and sporting goods
- Custom Mountain Bikes
- Sea Kayaks

TENDERS

- 1 Riva Limited Edition AquaRiva 100 'Cento'
- 1 Vikal Custom Limousine
- 1 Intrepid Custom 350 Open
- 1 Zodiac RIBO 420









CAKEWALK SPECIFICATIONS

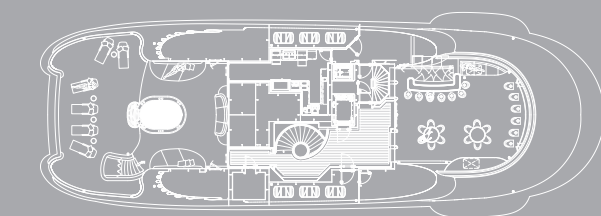
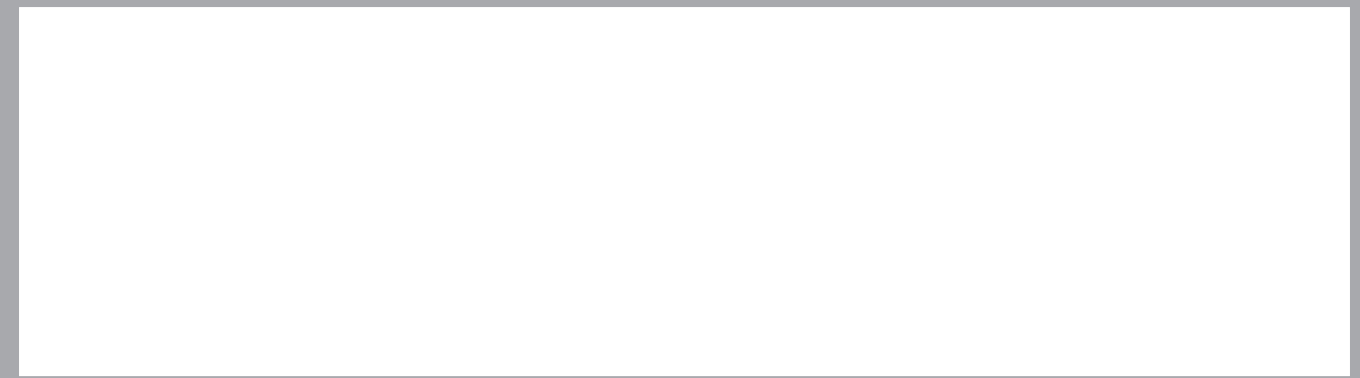

THE SUN DECK

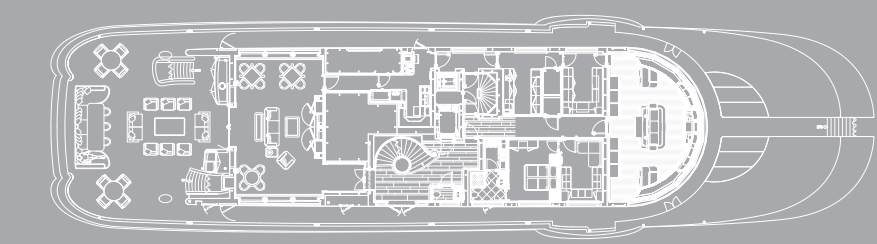

THE BRIDGE

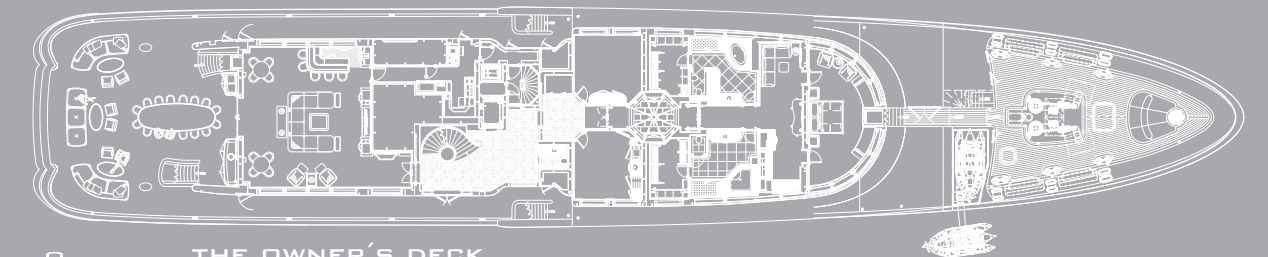

THE OWNER'S DECK

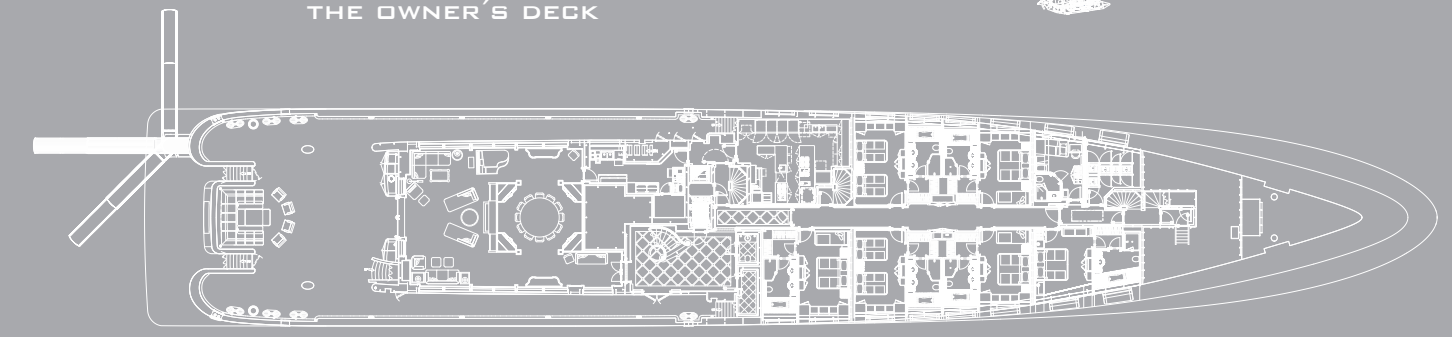

THE MAIN DECK

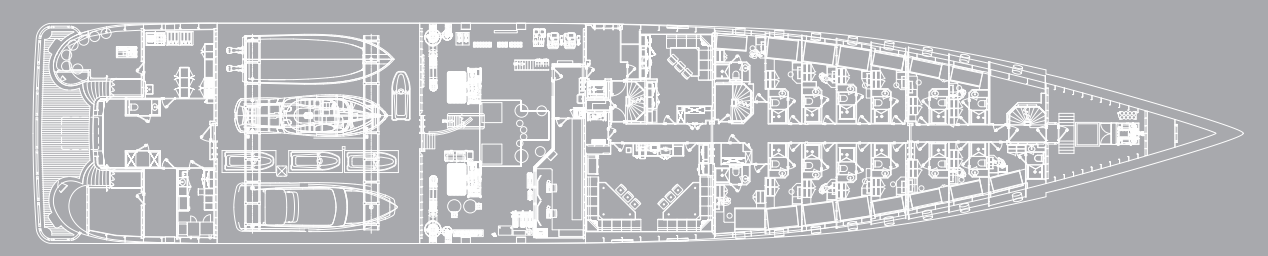

THE LOWER DECK

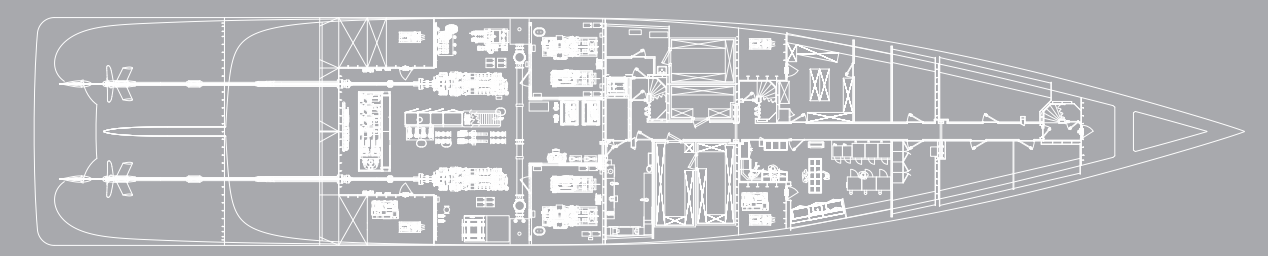

THE BOTTOM DECK



GENERAL SPECIFICATIONS

LOA	281.0ft (85.60m)
LWL.....	248.07ft (75.08m)
Construction	Steel hull, aluminum superstructure
Builder/year	Derecktor Shipyards/2010
Draught	13.1ft (4.0m)
Gross Tonnage.....	2998
Beam	46.92ft (14.30m)
Classification	Lloyds Maltese Cross 100A1-SSC Yacht(P) Mono G6
Speed (max/cruise)	17 knots/15 knots

MECHANICAL OVERVIEW

Propulsion.....	2 x 16V400M71 @ 2465bkw (3306hp) @ 2000RPM MTU
Propellers	2 x 5 blade Rolls Royce single pitch
Shafts	Rubber Design - Oil bath
Gearboxes	2 x ZF7666
Fuel capacity	370,000ltrs/97,000gal diesel (with onboard tender fill station)
Range	5000nm @ 15 knots (2 x mains, 1 x large & small genset with 15% fuel reserve)
Power generation.....	2 x MTU 2000 Series V12 M-40B @ 660ekw 2 x MTU S60 550 Series @ 350ekw
Emergency Power	1 x MTU S60 400 Series @ 275ekw
Stabilizers	4 x Quantam Zero Speed
Bowthruster	Jastram 400kw
Windlasses	Steen
Watermakers	2 x HEM Simplex 80 Series <8,421gal/day (<32,000l/day)
Shore power converters.....	Vectek 600kVa
Monitoring system.....	McKay
Electrical	McKay
Fire detection	Tyco Fire & Security - SimplexGrinnell
Fire suppression	Marioff Hi-Fog
Security system	Frankentech

COMMUNICATION & NAVIGATION

Telephone system.....	Panasonic KX T7400/T7700 Hybrid IP-PBX
VHF Comms.....	Icom (including aircraft communications)
Satcom F77	Nera
AIS.....	Furuno
Computer network	Great Circle Systems
Air horn	Kahlenberg
Autopilot/gyro compass	Raytheon Anschutz
DGPS	Raytheon
Charting System.....	Transas
Sounders & Sonar	Furuno
Speed Log	C-Plath Naviknot III
Radars	Raytheon S & X band
Speed, depth, wind meters	B&G
Navtex weather receiver	JRC

TENDERS

1 x Riva Limited Edition AquaRiva 100 'Cento' (Hull no. 9 of 10)	
LOA	32.8' (10.07m)
Engines	2 x Yanmar LYA/STP 370hp/272kw @ 3300rpm
Max speed	42 knots
Cruising speed.....	36 knots
Range	150nm @ 36 knots; 130nm @ 42 knots
1 x Vikal Custom Limousine	
LOA	36.7' (11.3m)
Engines	2 x Volvo D6 370hp Turbo Charged Diesels
Max speed	50 knots
Cruising speed.....	25 knots
Range	100nm @ 25 knots
1 x Intrepid Custom 350 Open	
LOA	34.5' (10.61m)
Engines	2 x Volvo D6 370hp Turbo Charged Diesels
Max speed	55 knots
Cruising speed.....	30 knots
Range	260nm @ 55 knots (189gal fuel with 5% reserve)
Zodiac RIBO 420	with Yamaha 40hp 4-stroke outboard

WATERSPORTS & OUTDOOR EQUIPMENT

- 4 x Yamaha FX Cruiser HO 1052cc 4-stroke Waverunners
- 1 x Custom Nitrox Solutions compressor with cascade dive tank fill system with storage bottles
- Complete SCUBA sets for guests and crew
- Full complement of wetsuits, diving and snorkeling equipment
- 2 x Sea Bob CAYAGO F7 water scooters
- Full complement of water skis, kneeboards, wakeboards and inflatable water toys
- Beach party equipment - BBQ, tent, chairs and tables
- Full complement of beach equipment and sporting goods
- Custom mountain bikes
- Sea kayaks

PROJECT PARTNERS

Audio Visual System	Advanced New Technologies (A-N-T) using Crestron Controls
Interior Design	Elizabeth Dalton, ASID – Dalton Designs, Inc.
Exterior Design	Tim Heywood Designs
Naval Architecture.....	Azure Naval Architects
Engineering Design	BMT Nigel Gee & Associates, Gibbs & Cox
Architectural Joinery Owner's Deck	Merritt-Vedder Woodwork
Architectural Joinery Main & Bridge Decks.....	Zepso Architectural Woodwork Inc.

CAKEWALK ACCOMMODATIONS

Owners and Guests..... 12 in 6 Cabins + Master
Staff cabin2 in 1 Cabin
Crew 24 in 16 Cabins

SUN DECK

Forward Deck:

- Observation Chairs
- Lounge Areas (Port & Stbd)
- Bar with Seating for 7
- Card Tables with Seating

Aft Deck:

- Lounge Area
- Sunbeds
- Whirlpool Spa

BRIDGE DECK

Forward Deck:

- Sunbeds
- Wheelhouse
- Ship's Office
- Captain's Cabin
- Captain's Office
- Crew Office
- Powder Room
- Salon:
 - Lounge Area
 - A.V. System
 - Card Tables with Seating

Aft Deck:

- Lounge Area
- Card Tables with Seating

OWNER'S DECK

Owner's Accommodations:

- Full Beam Accommodation with Panoramic View
- Stateroom with King Bed, A.V. System and Lounge Seating
- Separate Study/Lounge Area
- His & Hers Heads with Jacuzzis
- His & Hers Walk-In Dressing Rooms
- Gym
- Day Spa/Exercise Room
- Theater System
- Bar with Seating for 5
- Card Tables
- Lounge Area
- Powder Room

Aft Deck:

- 3 x Lounge Areas
- Dining Table (Seats 14)

MAIN DECK

Guest Accommodations:

- 4 x Staterooms With King Bed
- 2 x Staterooms With Two Double Beds
- 1 x Staff / Supernumery Cabin with Two Bunks

Dining Salon

Library with Faux Fireplace

Baby Grand Piano

Complete Guest Access Level Elevator

Aft Deck:

Deck Lounge Area

LOWER DECK

- 15 x Crew Cabins
- Officers' Mess
- Crew Mess
- Engine Room
- Inboard Tender & Waverunner Storage
- Lazarette Lounge Area
- Lazarette Dive Room
- Lazarette Powder Room

BOTTOM DECK

- Crew Gym
- Storage
- Laundry
- Engine Room

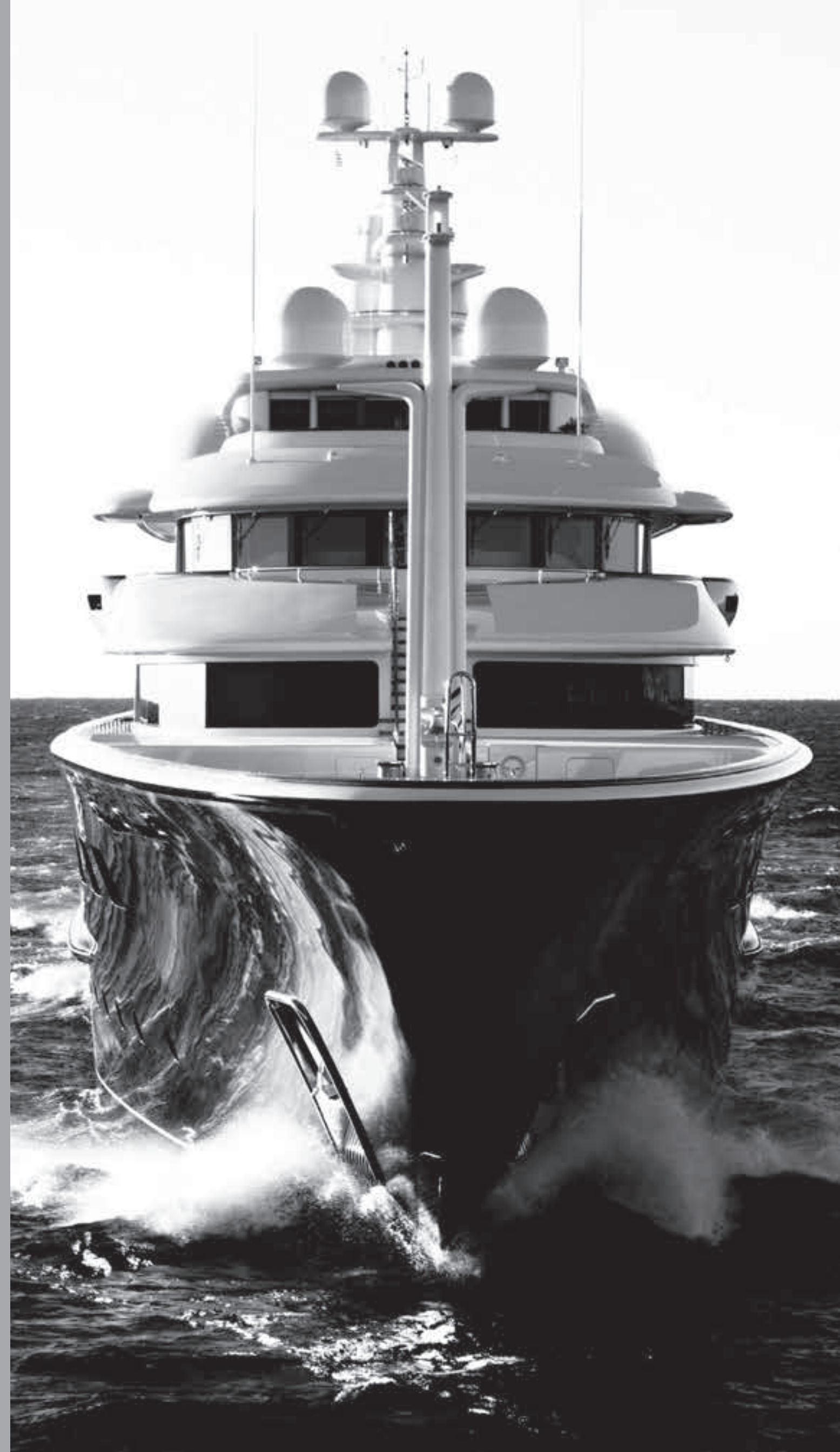



The century's new standard
in superyachting is now
yours to experience.

WELCOME TO CAKEWALK.

