



**force**









Delivered from the renowned Heesen yard in August 2006, G-FORCE offers a superlative combination of sleek exterior lines and elegant interior styling.

G-FORCE's sophisticated main saloon area has been beautifully finished; with blond sycamore panelling and cabinetry juxtaposed against the dark moor oak flooring.

The aft end of the saloon is given over to a round dining table with seating on ebony and cream leather chairs for eight guests, with the option of enlarging the table to accommodate ten. This leaves a spacious area forward for the lounge which has comfortable cream leather sofas.

At the end of the saloon a beautiful display unit of ebony Makassar sits against a mirrored wall, which also houses a 50" flat screen television. The silk woven carpets, bespoke furniture and exquisite detailing lend a classic yet contemporary look with a touch of Art Deco.

Adjacent to the main saloon area is the galley and pantry, where elegant black African granite is combined with understated black moor oak cabinets.

The bridge is equipped with the latest, state-of-the-art navigational instrumentation.





The full width Owner's stateroom and en suite bathroom is situated on the main deck forward of the saloon. This room has a luxurious feeling with the sycamore panelling delicately hand stencilled with a subtle Art Deco design and 42" TV. Ebony Makassar wood has been used for the custom made furniture which is offset beautifully by the cream silk and wool carpet. Soft furnishings in a symphony of pale and dark grey, taupe and beige compliment the mixture of sycamore and dark ebony finishings. This suite also has an extremely generous walk in wardrobe.

The spacious en suite bathroom boasts a large walk in shower and has his and hers vanity units. The room is finished with black African granite, Rosal Limestone marble, glass, mirrors with nickel accessories typifying the detail and splendour of the interior.







The guest accommodation consists of three elegantly designed and fitted double cabins, and an additional "children's cabin" with four single bunks.

Again, the blonde sycamore panelling pervades throughout these cabins, and together with the use of mirrors, this gives a light and spacious feel.

The colours and textures used in these cabins are refined, with cream woven wool and silk carpets, soft cashmere throws and taupe, beige and cream scatter cushions, yet each cabin has its own individual signature colour scheme.



## GENERAL SPECIFICATIONS

### HEESEN 3700 SERIES

<b>Length Overall</b> .....	37,30m	122'4"
<b>Beam Max.</b> .....	7,50m	24'7"
<b>Draft Max 1/2 Loaded</b> .....	2,20m	7'2"
<b>Displacement (mid)</b> .....	150 tons	330,000 lbs
<b>Fuel Capacity</b> .....	33m <sup>3</sup>	8,700 US Gallons
<b>Fresh Water Capacity</b> .....	8m <sup>3</sup>	1,585 US Gallons
<b>Grey/Black Water Capacity</b> .....	3m <sup>3</sup>	792 US Gallons
<b>Max. Speed (light)</b> .....	31 Knots	
<b>Range @ 10 Knots</b> .....	3,200 NM	

### Hull & Deck Materials

Marine grade Aluminum

**Engines** .....

Twin MTU 16V4000 M90

**Power** .....

2 x 2.720 kW @ 2100 rpm

**Designer**.....

Omega Architects

**Builder** .....

Heesen Yachts Netherlands

**Interior Designer**

Jean Pierre Gilardino

Designs

### Classification

ABS Maltese Cross A1 Yachting Service AMS

MCA SRC COMPLIANT

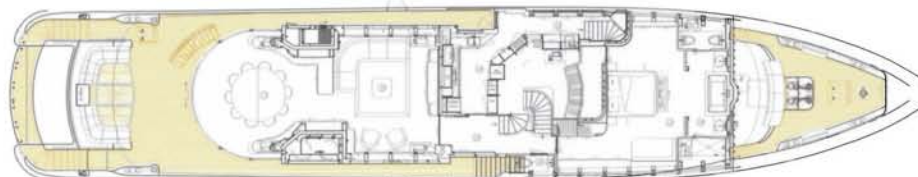
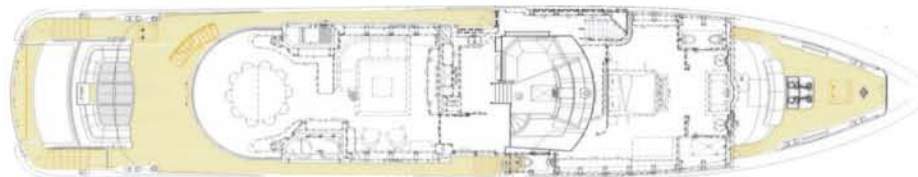
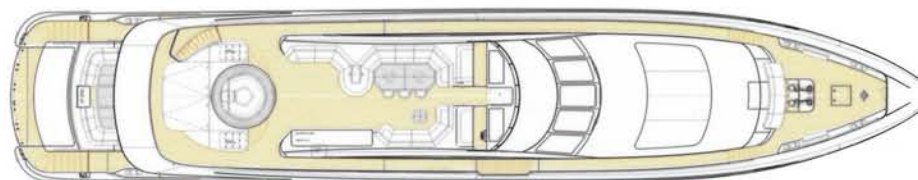



Gforce

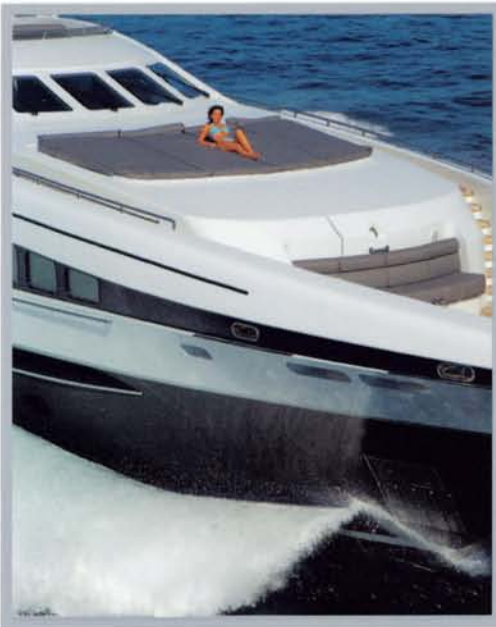

Out on deck G-FORCE offers her guests plenty of space for lounging and outdoor living. The sun deck is extremely spacious for a yacht of this size and boasts a large Jacuzzi surrounded by comfortable sunpads. This area also houses a wet bar, a tepanyaki grill and a large shaded dining area.

Forward of the bridge there is an additional sun-padded area offering superb panoramic vistas underway.

On the main deck is a more formal, al-fresco dining area for relaxing with cocktails and taking in the sunsets.

G-FORCE comes equipped with a 3 man Seadoo jet ski and also an 18ft Jet tender, ready to whisk guests away on shore excursions.

With speed capabilities of up to 31 knots and great outdoor living and lounging areas, G-FORCE will really live up to the expectations of her charter guests.













**Gorce**