

LA MASCARADE



FEADSHIP

ROYAL DUTCH SHIPYARDS



compact power



M/Y La Mascarade is a luxury yacht built by Feadship in 1997. She has just been re-launched after a comprehensive refit, including mechanical updates and a new interior design.

She measures 30m (98.4 feet) in length and is able to accommodate up to 8 guests in 4 double cabins. This luxury yacht is the world's only modern 30m Feadship, specifically built to include all of the qualities and benefits of a 50m superyacht. La Mascarade has recently been updated to include state-of-the-art zero speed gyro stabilizers. These are complemented by fin stabilization technology, ensuring comprehensive stability both at anchor and under way.

relax





Walking across the passerelle onto La Mascarade is a delight. As soon as you arrive you will be impressed by the craftsmanship and design of the yacht. Canapés are often served on the main aft deck dining area affording views back onto the quay or the sea.





sun deck

La Mascarade also offers huge exterior deck space where the large sofa areas can be converted into a spacious sunbathing area. There is a removable awning, providing excellent shade from the midday sun. Candle-lit dinner can be served on the sun deck overlooking the Mediterranean.

spacious



La Mascarade can accommodate up to 8 guests in 4 comfortable double cabins. The Master State Room is located on the main deck with natural light flooding through the large panoramic windows. A calming ambience pervades, with luxury soft bed linen and beautiful ornaments. There is an adjoining dressing room which leads into the ensuite bathroom, where you can refresh yourself in the shower or pamper yourself in the jacuzzi bath.







saloon

The interior has a simple calm contemporary design, giving a feeling of light, space and well-being. This has been complemented by the quirky colourful Ecuadorian sculptures by Miguel Illescas, with the friendly Iguana "Igggy" managing the bar! The synergy of the natural limed oak together with the richness of the wenge wood contrasting with the soft lush carpets gives the yacht a feeling of warmth, luxury and comfort.





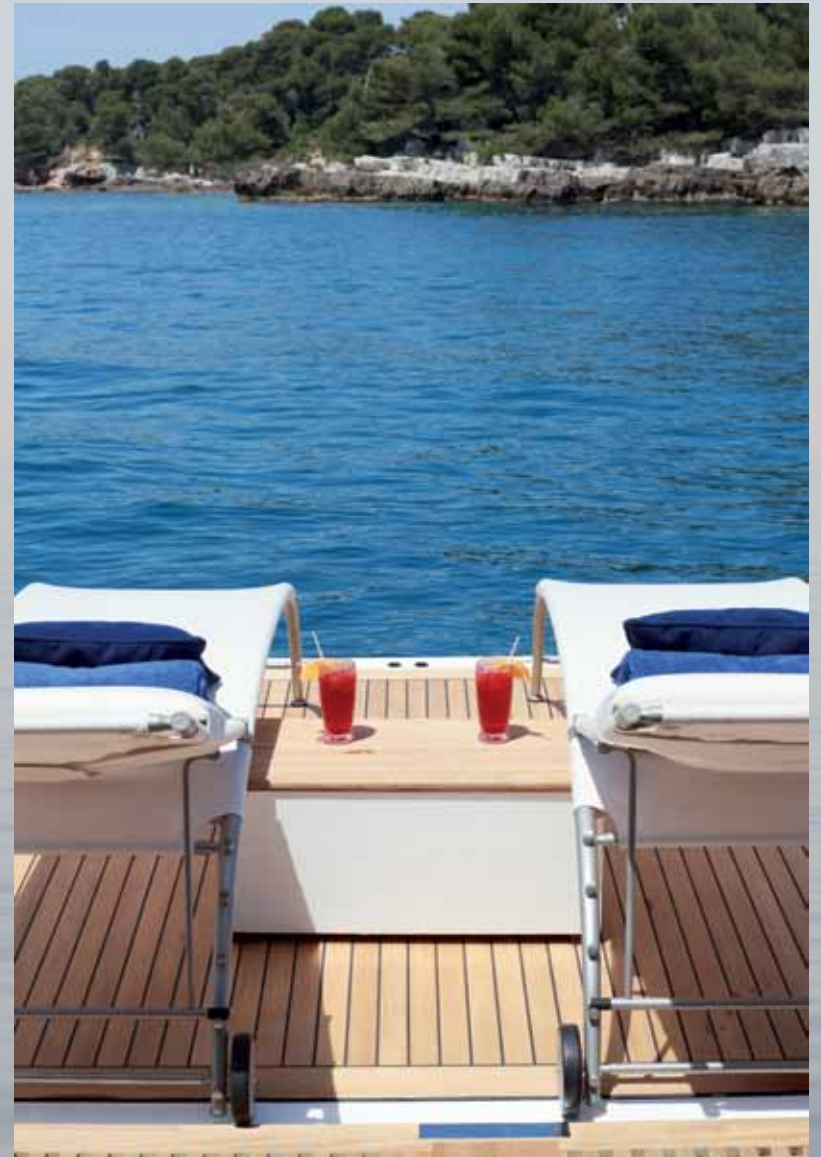



vip cabin

The luxurious VIP State Room boasts a large TV and a comfortable large double bed with sumptuous soft bed linen. It has a walk-through dressing area which leads into the large ensuite bathroom.



guest cabins

The other two beautifully appointed guest rooms offer double beds, ensuite bathrooms with full size walk-in showers. Media entertainment is provided by flat screen TVs via a Sonos sound system server (controlled by an iPad Mini) which offers a generous library of many different musical genres, Sky TV and a wide selection of DVDs. Internet access is available via 3G WiFi throughout the yacht. All areas of the yacht are air-conditioned with each cabin offering separate temperature control.





water sports

The yacht offers a fabulous selection of water sports equipment, including a 4.5m tender, an inflatable kayak, water-skis (adult and children), a wakeboard, 2 towable doughnuts, 2 Seadoo diving scooters, 2 stand-up paddle boards and windsurfers. Kitesurfing equipment is available on request. There are noodles and multiple sets of fins, snorkels and masks along with some fishing gear.



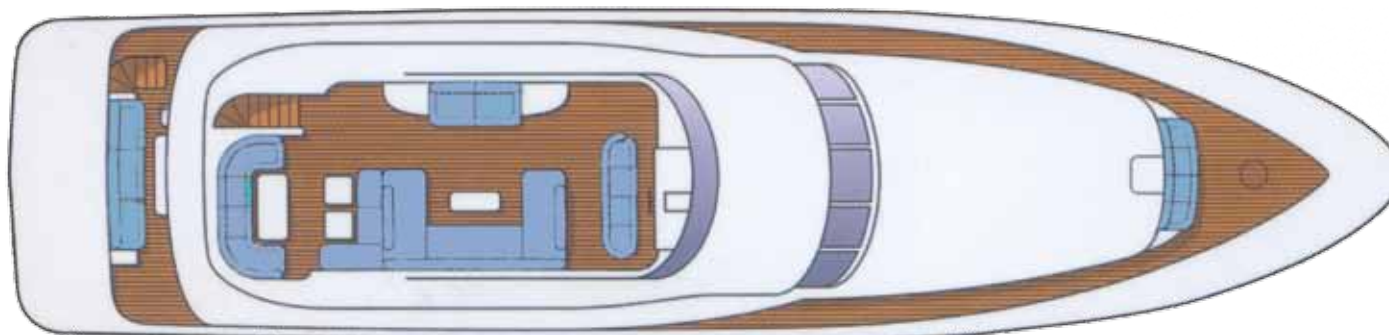
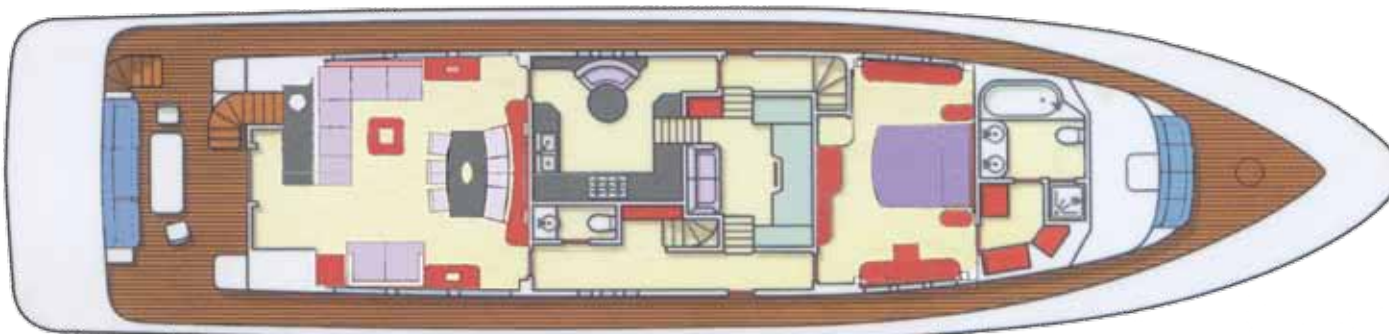
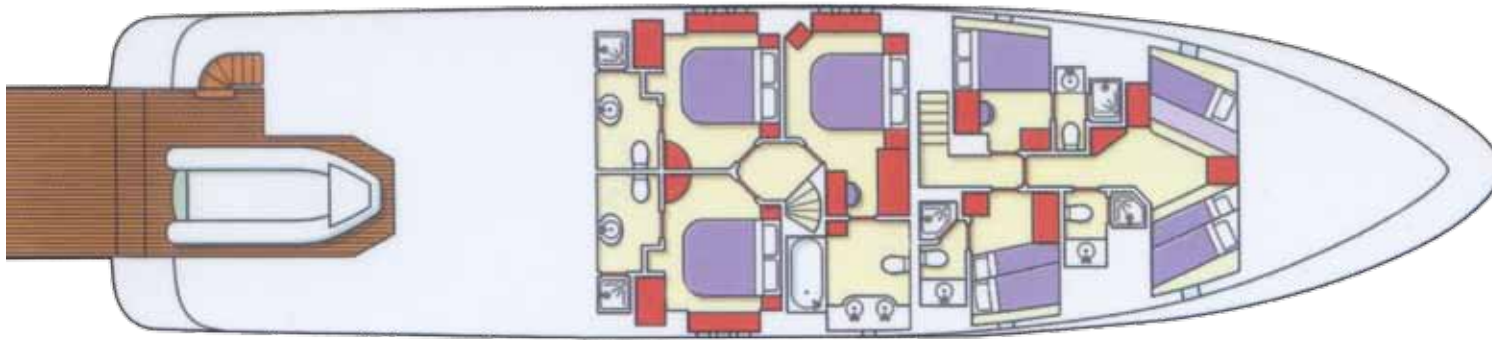

Length: 30m
 Beam: 7.10m
 Draft: 2.0m
 Hull Material: Aluminium
 Cruising Speed: 14 knots
 Maximum Speed: 16 knots
 Builder: Feadship
 Naval Architect: F. de Voogt
 Crew: 5/6 crew in 3 cabins
 Flag: British
 Main Saloon: Panasonic 67" OLED TV with Blu-ray DVD/CD iPad Mini
 Master & VIP Cabins: LCD TV with Blu-ray DVD/CD iPad Mini
 Guest Cabins: LCD TV with Blu-ray DVD/CD iPad Mini



FEADSHIP
 ROYAL DUTCH SHIPYARDS

technical

Engines:	2 x Caterpillar 3412 1250hp @ 2300rpm
Generators:	2 x Caterpillar D3304 (80Kva & 50Kva)
Fuel:	23,480 litres
Fresh Water:	7,380 litres
Range:	1,500 nm
Gross Tonnage:	190
Bowthruster:	Vosper VT40 - 50hp
Stabilisers:	Vosper fins Seakeeper 2 x M26000 zero speed Gyro stabilisers
Water Makers:	2 x HEM @ 220 lph
Air Conditioning:	Aqua Air 180,000 Btu (to all areas)
Fuel consumption:	300 litres per hour at cruising speed



The pilot house has received a comprehensive refit with navigation equipment updates including four flat panel screens and the latest bridge navigational watch alarm system. It is also home to the central control of the media server that is distributed to all televisions throughout the yacht.

