

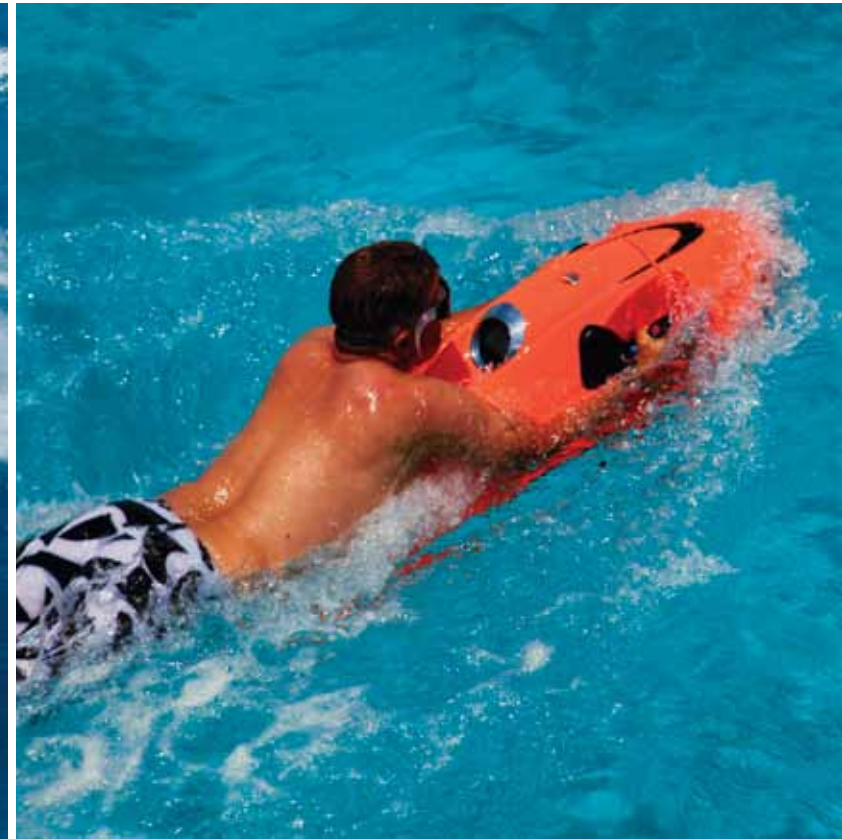

*Milk Money*



*Welcome to your next Paradise*



MAIN AFT DECK





FLYBRIDGE

*Exterior Spaces*

Enjoy a casual brunch on the Main Aft Deck with accommodations for eight, including a full wet bar and fabulous views.

The Flybridge features a large Jacuzzi, fully stocked bar with five stools, barbeque grill and a complete sound system for all your entertaining needs.



FOREDECK

MAIN SALON





DINING SALON



*Main Salon  
& Dining Salon*

The Main Salon is entered through the custom stainless steel framed sliding doors from the Main Aft Deck. As soon as you enter the Main Salon you are welcomed by its elegant and sophisticated appearance. Some of her amenities includes a full entertainment system, pop up flat screen television and a full bar.

A prepared culinary delight awaits for you in the formal Dining Salon with seating for eight guests comfortably.

GALLEY







## *Galley & Pilothouse*

*A* gourmet country style Galley faces a large settee designed for a more informal meal. This area of the yacht is most popular due to the casual nature of the exhibition-style Galley. Indirect lighting makes this a place to enjoy any dining experience.

MASTER STATEROOM





## *Master Stateroom*

*T*he richly furnished, full-beam Master Stateroom is located amidship, providing your own private oasis. This luxurious stateroom offers a California King size bed with top of the line entertainment center and his & hers bath with Whirlpool tub and shower.

VIP STATEROOM



QUEEN STATEROOM



QUEEN BATHROOM

TWIN STATEROOM



## *Guest Staterooms*

Each of the three guest staterooms are all equal with the finest luxury amenities such as en suite baths with shower & vanity, marble counter tops, plush linens and entertainment centers. The Twin Stateroom can easily be converted into a King size bed.



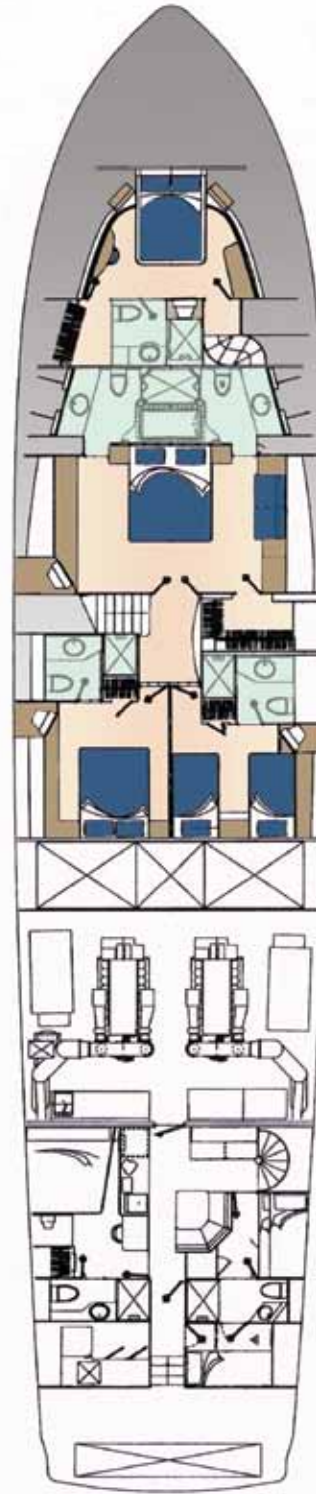
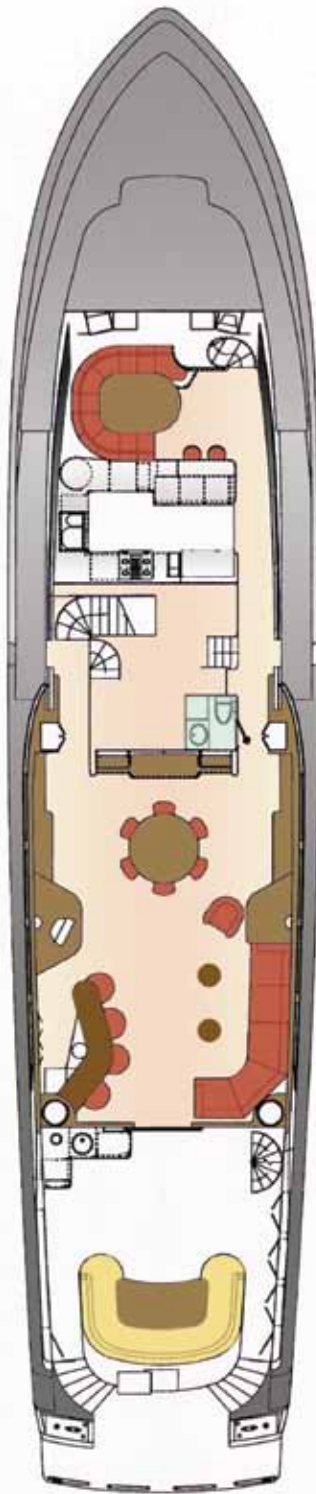
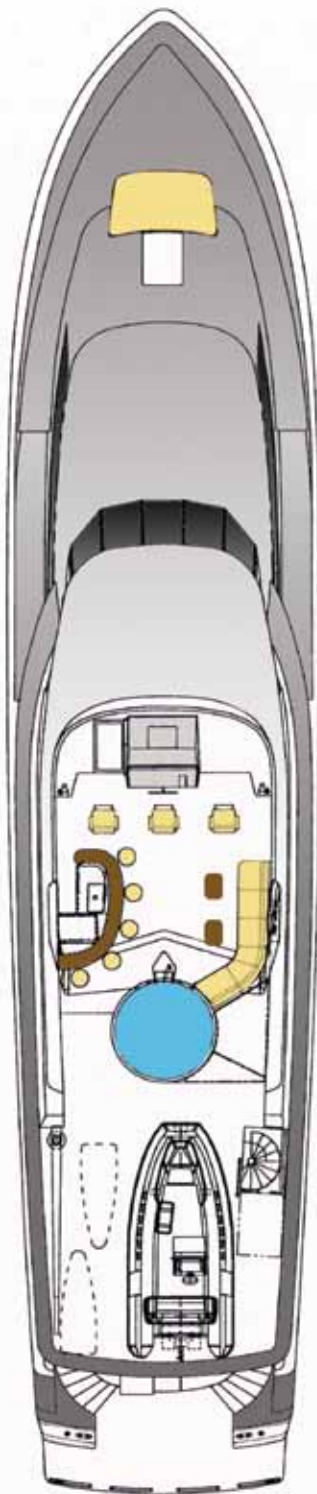

## SPECIFICATIONS

Builder:	Westport
Year:	2001
Length:	112'
Beam:	24'
Draft:	5' 6"
Staterooms:	4
Crew:	5
Speed:	Cruise 20 knots Max 25 knots
Fuel:	5,500 gal.

## TENDERS & TOYS

26' Regulator with twin Yamaha 4-stroke engines - Not Available in New England.

4 x Seabob Underwater Toys

2 x Yamaha 150 3-Man Waverunners

18' Novurania w/130 hp engine

Snorkel Equipment

Water Skis

Towable Tubes

Wakeboard

Beach Party Equipment

Fishing Gear

6-Man Banana

Rendezvous Diving Only

