



# NEXT CHAPTER

180' 6" (55m) | Benetti | 2003

# NEXT CHAPTER

## BASIC SPECIFICATIONS

---

### BUILDER

Benetti

### BEAM (ft/m)

34' 2" (10.4m)

### CRUISING/MAX SPEED

14 / 16 Knots

### CREW

14

### RANGE

7000 nm

### LENGTH (ft/m)

180' 6" (55m)

### DRAFT (ft/m)

10' 3" (3.12m)

### FUEL CONSUMPTION

90 US Gall/Hr

### ACCOMMODATION

12 guests in 6 cabins

### INTERIOR DESIGNER

Stefano Natucci

### BUILT/REFIT

2003 / 2023

### GROSS TONNAGE

909 GT

### ENGINES

2 x Caterpillar 3512B - 1,850hp

### ARRANGEMENTS

4 Double, 2 Twin

# NEXT CHAPTER

## KEY FEATURES

---

- › SPLIT LEVEL MASTER STATEROOM WITH OBSERVATION LOUNGE
- › VIP STATEROOM ON UPPER DECK
- › AIR CONDITIONED GYM ON SUN DECK
- › TOURNAMENT FISHING & SPEARFISHING GEAR
- › 45' (13.7M) 2020 SEAHUNTER TOURNAMENT WITH QUAD 425HP YAMAHA - TOWED TENDER

# NEXT CHAPTER

## WATER TOYS

---

- › 45' (13.7M) 2020 SEAHUNTER TOURNAMENT WITH QUAD 425HP YAMAHA
- › 2 X 2022 SEA DOO SPARK TRIXX
- › 2 X SEABOBS
- › KNEEBOARD
- › INFLATABLE TRAMPOLINE
- › 19' (5.8M) NOVURANIA
- › 1 X 2022 FLITEBOARD
- › 2 X STAND-UP PADDLE BOARDS
- › WAKEBOARDS & TOWABLE TOYS
- › SNORKELING GEAR
- › 13' (3.9M) INFLATABLE RHIB AB TENDER
- › 2 X SEA KAYAKS
- › WATERSKIS
- › WATERSLIDE FROM BOW
- › TOURNAMENT FISHING & SPEARFISHING GEAR (OFFERING AN EXPERIENCED FISHING PROGRAM WITH \$100,000 - \$150,000 ANNUAL BUDGET ON FISHING SUPPLIES.)

# NEXT CHAPTER

## WATER TOYS

---

- › BEACH BBQ































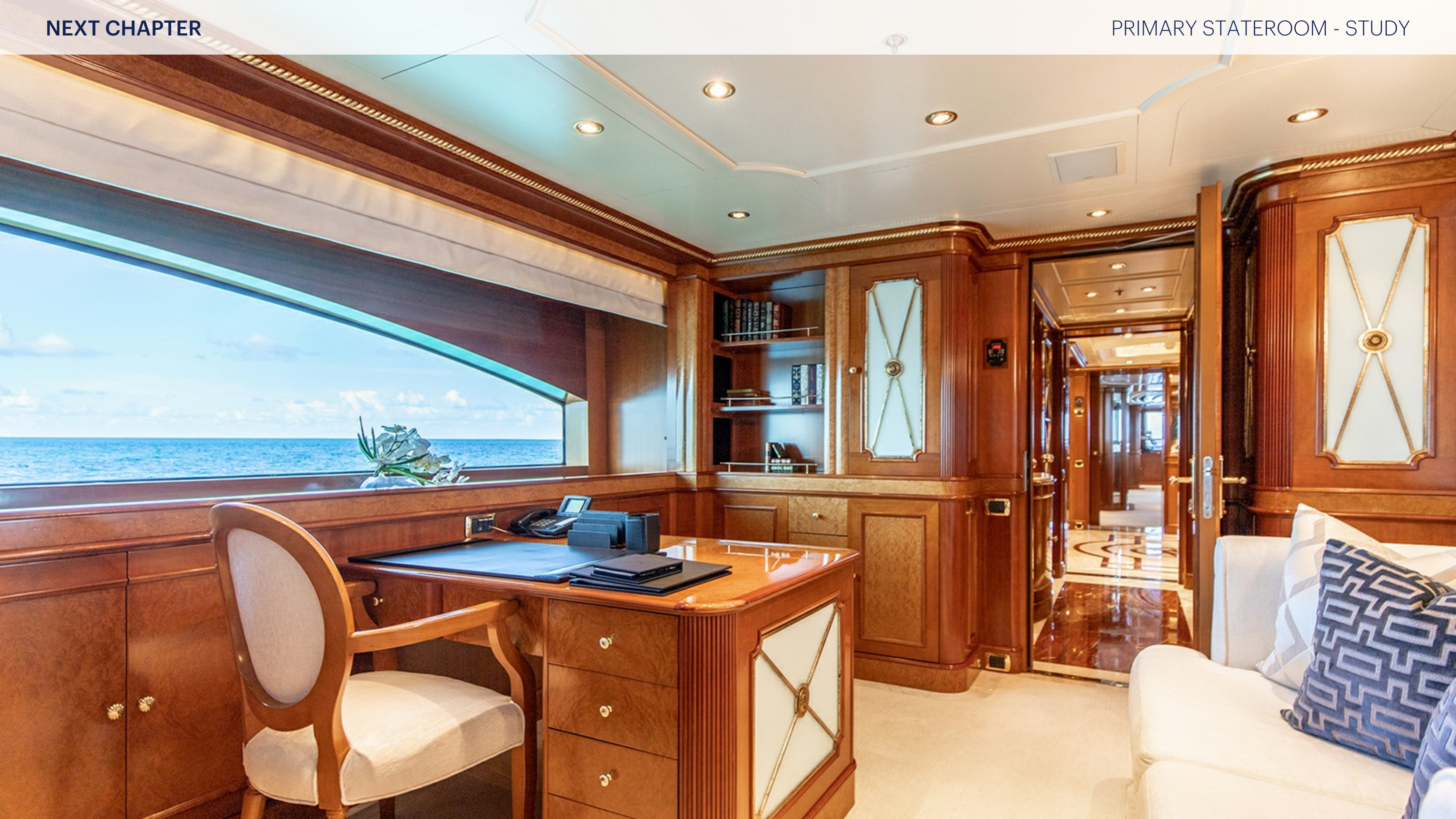





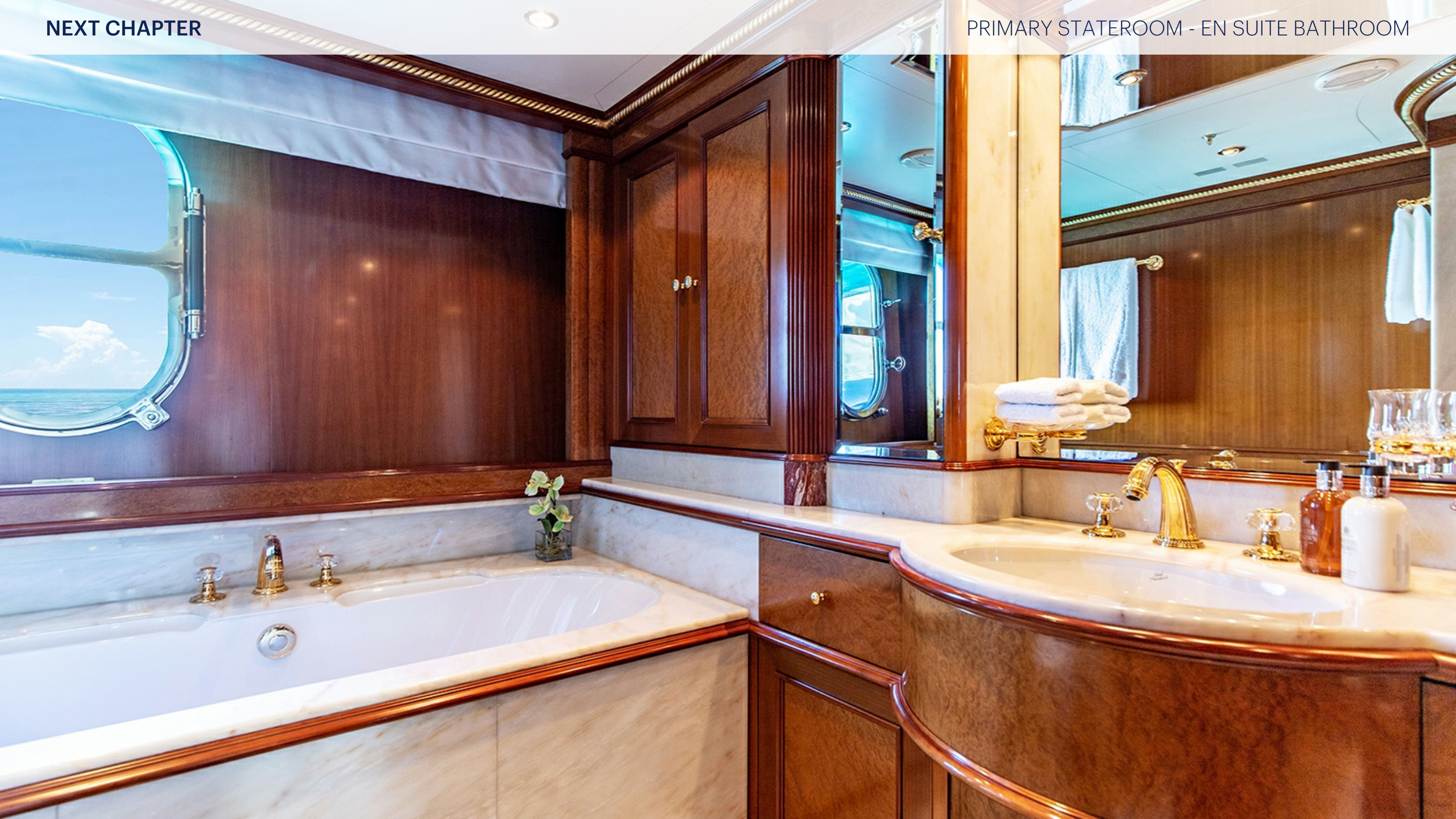





































NEXT CHAPTER













































NEXT CHAPTER



















NEXT CHAPTER

SEABOB









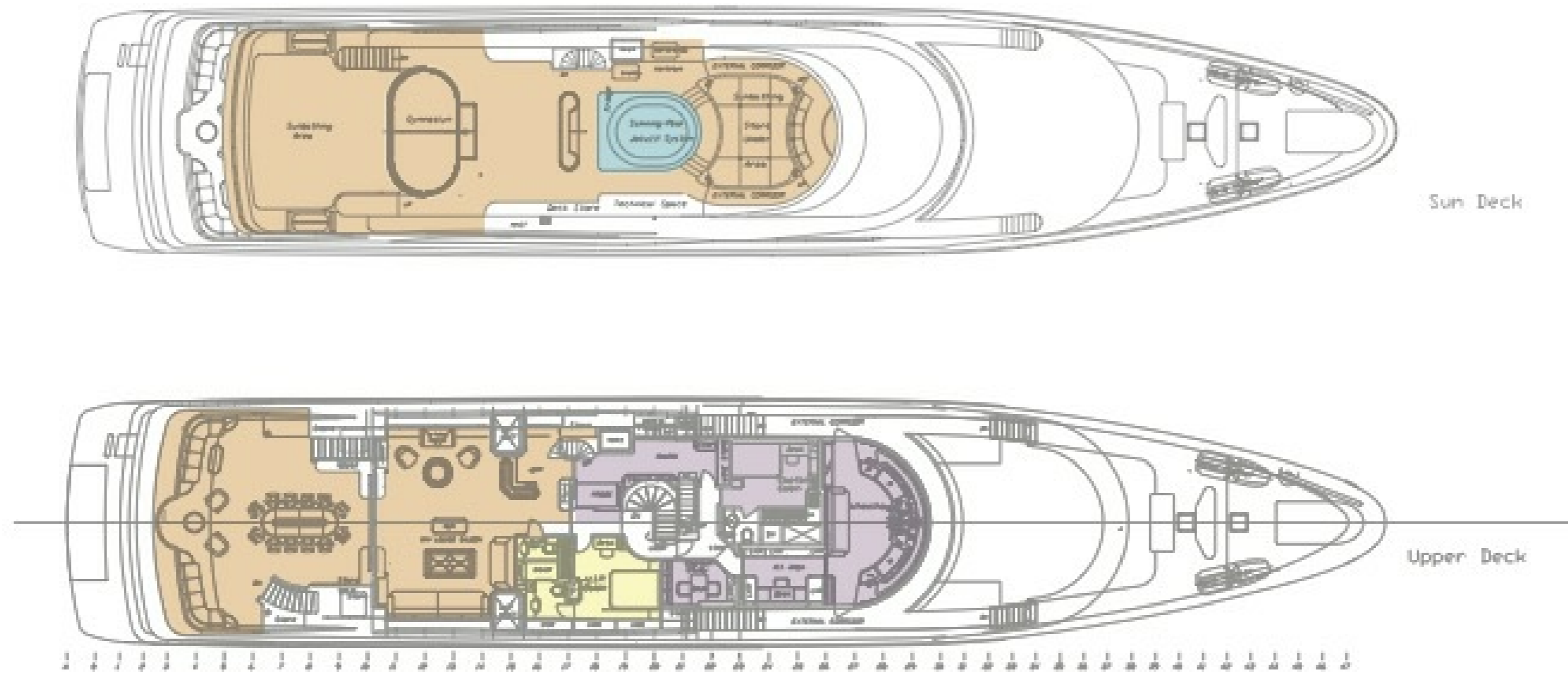

- STATEROOMS
- JACUZZI
- GUEST COMMON AREAS
- CREW AREAS
- ENGINE ROOM

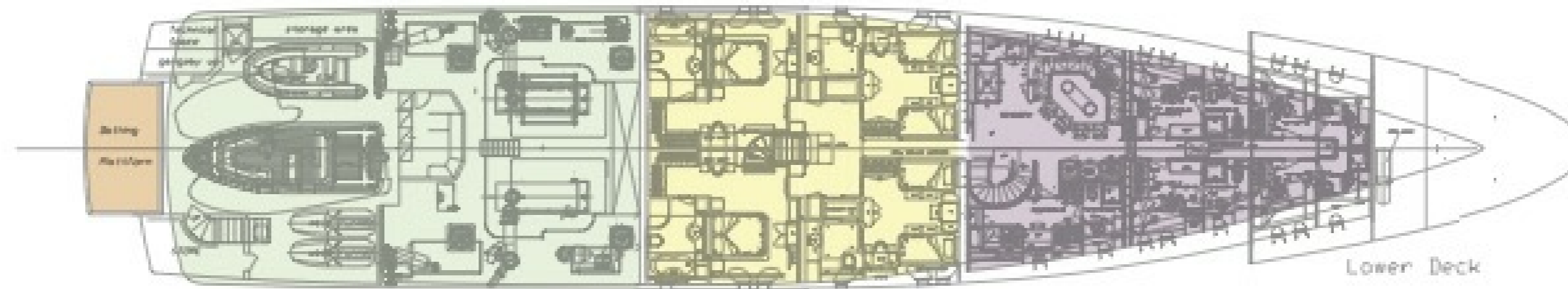
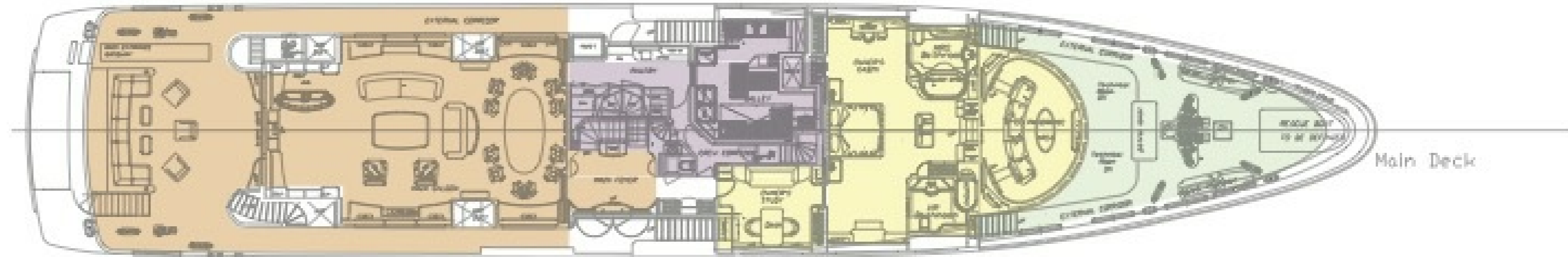

- STATEROOMS
- JACUZZI
- GUEST COMMON AREAS
- CREW AREAS
- ENGINE ROOM