

FOR CHARTER

PALOMA



BUILDER	ISHIKAWAJIMA HARIMA
BUILT / REFIT	1965 / 2004
BEAM	8.85M / 29'
STATEROOMS	7
GUESTS	12
CREW	15
SPEED	15 KNOTS / 16 MAX

CRUISING AREA SUMMER

**ITALY, GREECE & THE
ADRIATIC SEA**

CRUISING AREA WINTER

PLEASE ENQUIRE

WEEKLY RATE HIGH

€ 170,000

WEEKLY RATE LOW

€ 160,000

EXPERT'S VIEW

"Classic motor yachts lovers will find their own treasure with M/Y PALOMA, one of the very few available for charter. Built in 1965, totally rebuilt between 2003 and 2004, this world cruiser charter yacht has crossed the Atlantic more than 20 times. PALOMA engaged additional refits in 2018 and 2020 and is now presented in stunning condition. A capable, custom-built at Ishikawajima-Harima shipyard in Japan, and reliable vessel. Ideal for large families with a seven-stateroom layout for 12 guests, PALOMA can bring you everywhere thanks to her Transpacific range."

Yachts offered are subject to availability. The particulars are believed to be correct but are not guaranteed and may not be used for contractual purposes. Specification provided for information only.



AFT DECK DINING

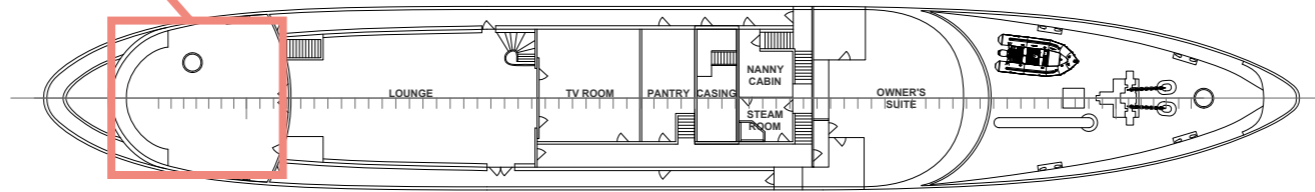

MAIN DECK



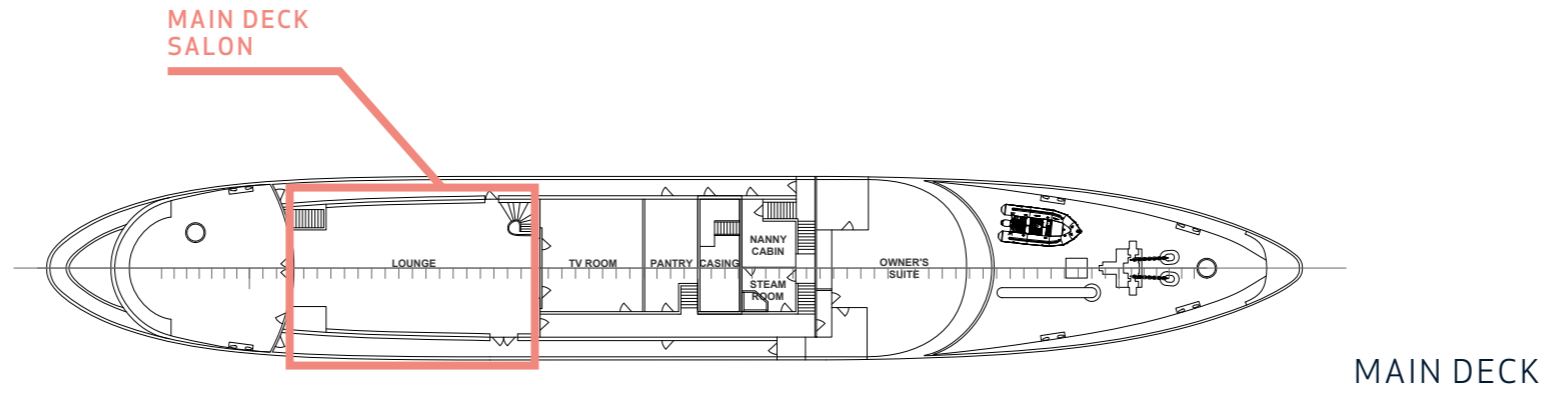







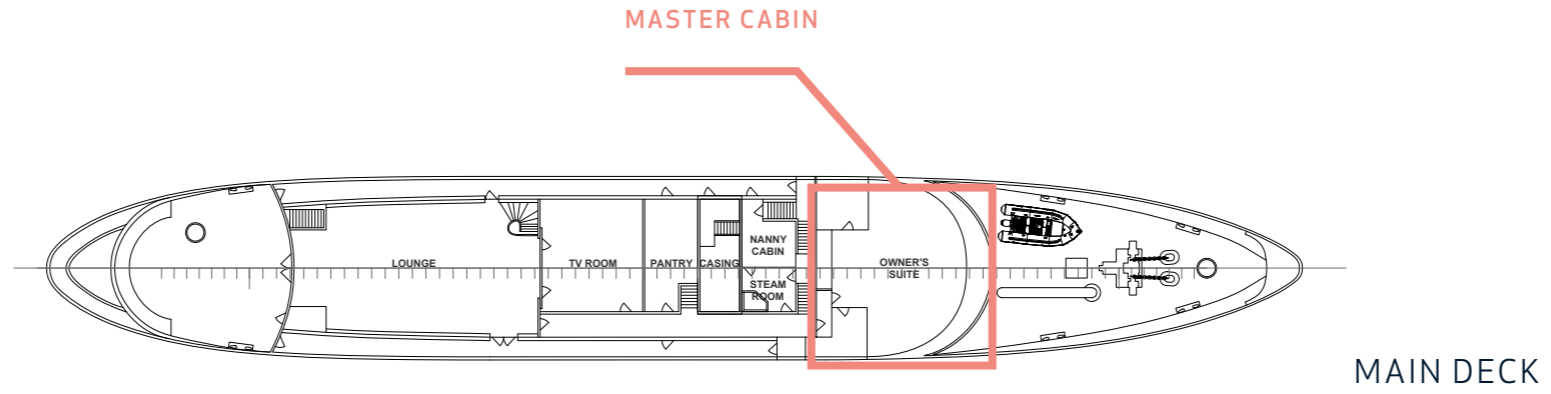



GUEST CABINS
AND ENSUITE

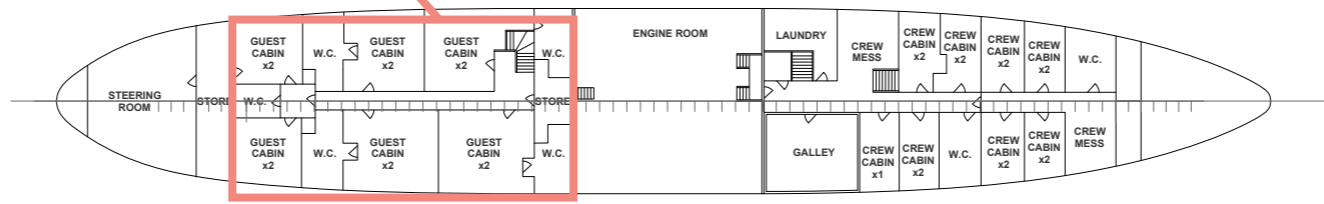

LOWER DECK









UPPER AFT DECK

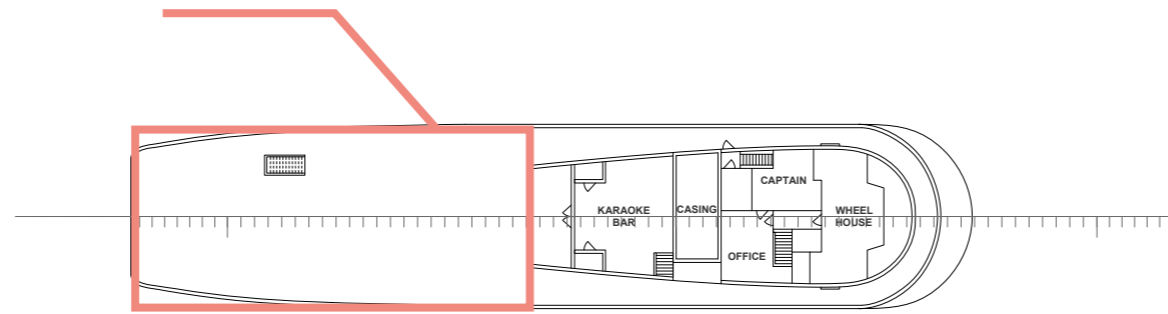

UPPER DECK







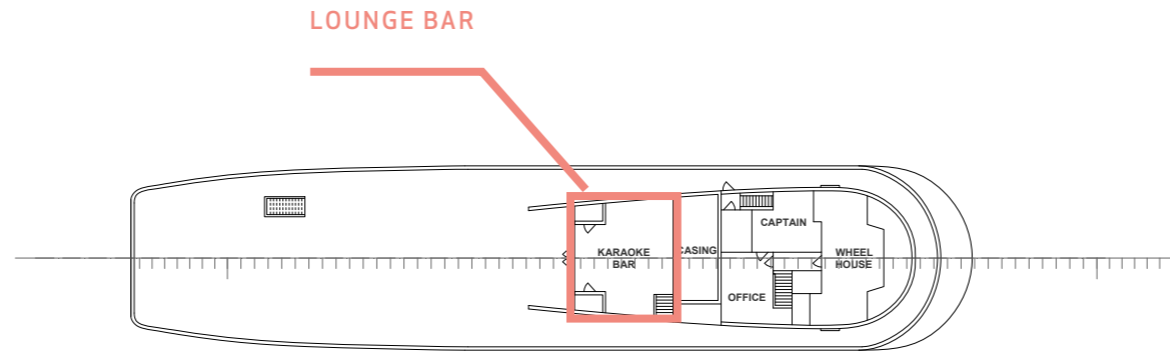

UPPER DECK





SUN DECK

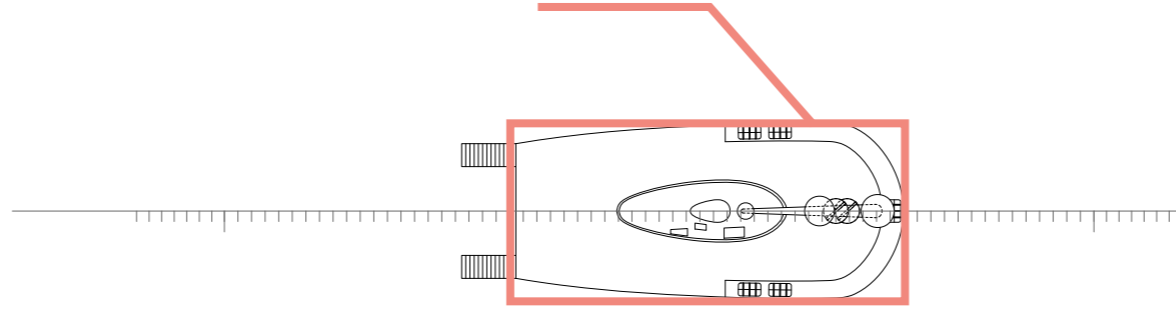

SUN DECK







PALOMA
SOUTHAMPTON

TENDERS & WATER TOYS

2X RIB 646 550 TENDERS 115 HP YAMAHA

1X DSB 3.90M WITH 20 HP OUTBOARD

1X WAVERUNNER

2X KAYAKS

2X PADDLE BOARDS

WATERSKIS

DOUGHNUTS

SNORKELING EQUIPMENT

DIVE COMPRESSOR & SCUBA EQUIPMENT
(RDV DIVING ONLY)

Yachts offered are subject to availability. The particulars are believed to be correct but are not guaranteed and may not be used for contractual purposes. Specification provided for information only.

YACHT FOR CHARTER | PALOMA | 60.10M / 197' 2" | GENERAL ARRANGEMENT

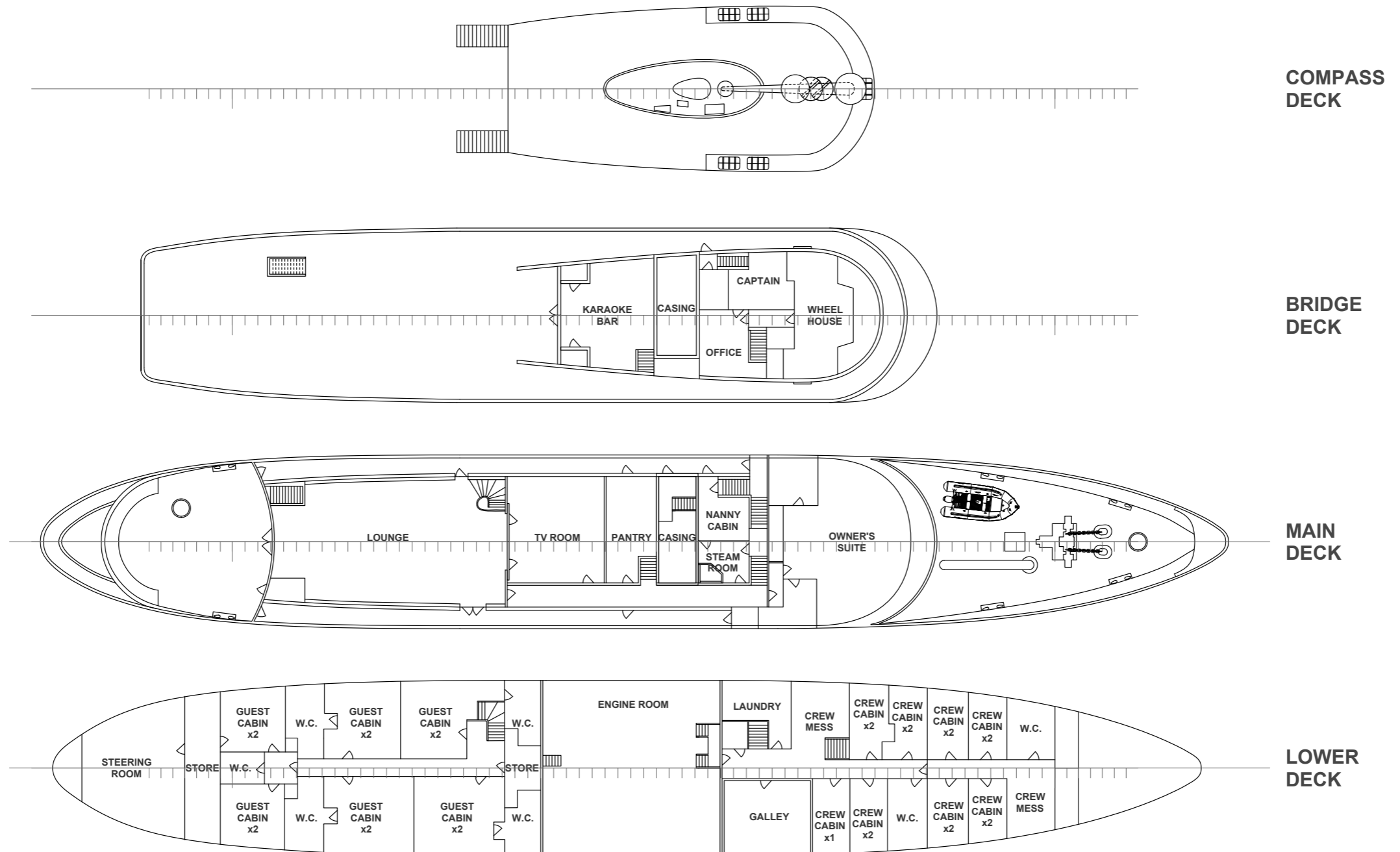

Yachts offered are subject to availability. The particulars are believed to be correct but are not guaranteed and may not be used for contractual purposes. Specification provided for information only.